





Norlys manufactures high quality exterior lighting for the professional and discerning lighting business with our products typically sold through Electrical Wholesalers and quality retailers in more than 20 countries.



Norlys is a Scandinavian company with a 50 years history in the professional lighting business and it continues to ensure that all products are designed and produced in typical robust Scandinavian fashion; quality, detail, function and design are at the heart of every Norlys fitting, well able to withstand tough climatic conditions.

Our own 12000m square production facilities, based in Europe, allow us total control of the whole manufacturing process from conception to the finished article. Our constant aim is to produce lighting fixtures of outstanding quality and design. This is confirmed by the ISO 9001 accreditation and certification of our factory.



Our large range of galvanised steel fittings offers a totally new approach to decorative exterior lighting. The use of zinc alloy, prior to galvanisation, gives the product a finish that is more durable than steel, thus protecting the product from all kinds of damage, scratches and knocks. This, in turn, gives the product a very high level of protection against corrosion.

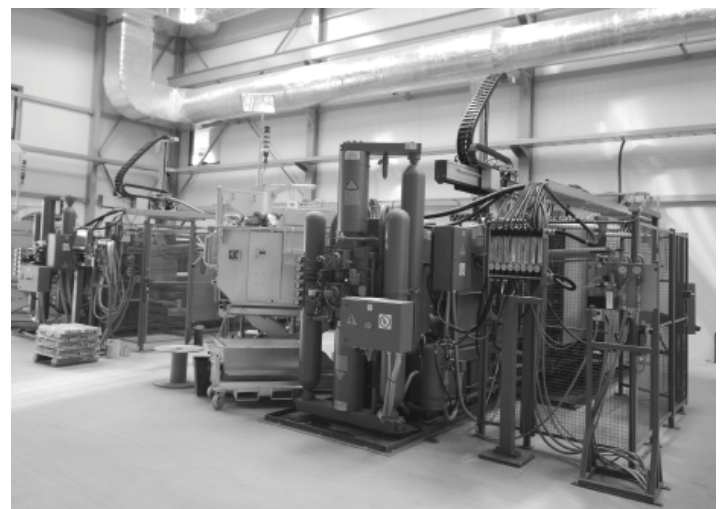

Our production process varies from the handmade CHELSEA range (page. 88) to highly automated production through use of CNC machines.

The multistage surface treatment, used prior to powder coating on certain models, ensures excellent resistance against corrosion. Continuously inspected for correct temperature and chemical consistency by our in-house chemist, the painting and treatment system is one of the most advanced used in lighting manufacturing in Europe. All these technical features result in the following key points.

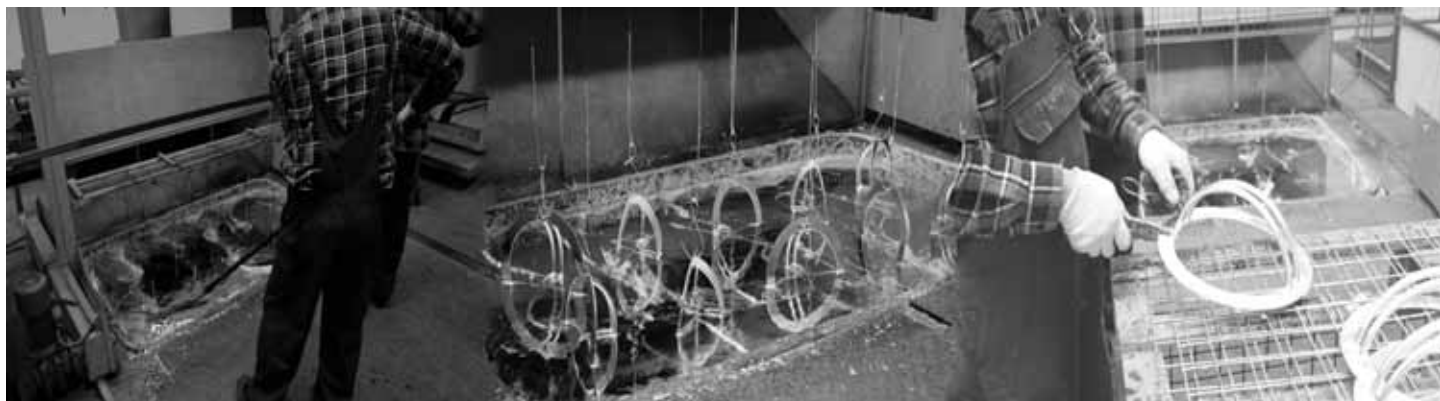

- Multistage pre-painting-treatment on all aluminium components including chromate dipping prior to powder coating.
- Multistage pre-treatment for all painted steel items.
- Corrosion warranty on all aluminium parts.
- Anti corrosion warranty on galvanised and painted steel fittings.
- Copper fittings are supplied in a raw finish to allow natural patina over time.
- Low energy option on most fittings.
- Choice of different colour options per range, including several hand patina options after request.



INDEX

ALTA	p. 62, 63	LUND	p. 78, 79
ARENDAL	p. 56, 57	MODENA	p. 106, 107, 108
ARVIKA	p. 65		p. 109, 110, 111
ASKER	p. 32, 33	MOLDE	p. 64, 65
BASEL	p. 48, 49	NARVIK	p. 18, 19
BAVARIA	p. 87	NICE	p. 10, 11
BERN	p. 46, 47	NORDKAPP	p. 54, 55
BERGEN	p. 86, 87	NORDLAND	p. 52, 53
BERLIN	p. 76, 77	OSLO	p. 80, 81
BODEN	p. 50, 51	PARIS	p. 82, 83
BOLOGNA	p. 97, 98, 99	RENA	p. 30, 31
BORNHOLM	p. 44, 45	RIMINI / MILANO	p. 96
BREMEN	p. 74, 75	ROMA	p. 95
CHELSEA	p. 88, 89, 90, 91	RONDANE	p. 42, 43
COMO	p. 112	SANDE	p. 20, 21
FIRENZE	p. 113	SANDVIK	p. 36, 37
GENEVE	p. 34, 35	SCANDINAVIAN WOOD	p. 60, 61
GENOVA	p. 92, 93	STAVANGER	p. 16, 17
GENOVA MINI	p. 92	STOCKHOLM	p. 66, 67, 68, 69
GLASGOW	p. 94, 95		p. 70, 71, 72, 73
GRIMSTAD	p. 28, 29	SUNNFJORD	p. 6, 7
HALDEN	p. 40, 41	TANUM	p. 20
HALMSTAD	p. 58, 59	VASA	p. 38, 39
HAMBURG	p. 76, 77	VENEDIG	p. 92
HELSINKI	p. 26, 27	VISBY	p. 8, 9
KARLSTAD	p. 84, 85	VOSS	p. 22, 23
KIRUNA	p. 27		
KOSTER	p. 13, 14, 15	TELESCOPIC POLE	p. 12
LATINA	p. 95	*ACCESSORIES	p. 114, 115
LILLEHAMMER	p. 24, 25		
LONDON	p. 100, 101, 102		
	p. 103, 104, 105		

Black/green



Graphite RAL 7016



Copper



Black/silver



Aluminium, RAL 9006



Galvanized steel



Black/Copper



White, RAL 9003

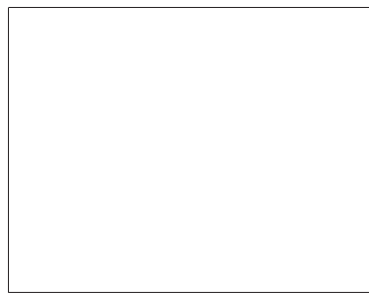



Black/Gold

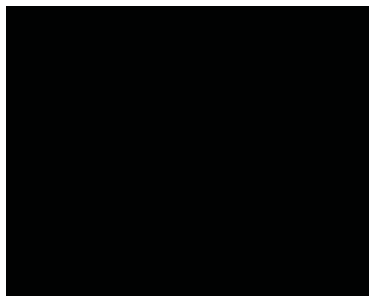

Black, RAL 9005

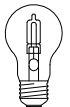

As GLS lamps are being phased out over the next few years the table below shows the alternative halogen lamps that can be used. Eg. If 60W is the recommended GLS wattage then please use max. 42W halogen lamp.

	
HALOGEN	GLS
28W	40W
42W	60W
53W	75W
70W	100W

Look for LED products: See the green house





ART. 1507 & 1508



ART. 1505 & 1506

SUNNFJORD



For photometric data contact supplier or log on to www.norlys.com

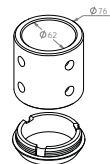
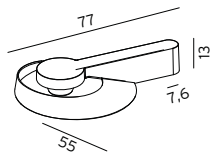

SUNNFJORD

IP65, class I
Ideally suited for use in communal areas such as car parks and walkways, Sunnfjord is a powder coated aluminium head.

For use on posts with 76mm external diameter at top.

Art. 1505
150W HIT, G12
Aluminium, 1505AL
Graphite, 1505GR

Art. 1506
70W HIT, G12
Aluminium, 1506AL
Graphite, 1506GR

* Lens for Art. 1505 and 1506 is frosted

Art. 1507 
54W LED
Aluminium, 1507AL
Graphite, 1507GR

LED module
- 54W LED
- 6000 lumen
- Up to 50 000h
- Warm white, 4000K
- Replaceable light module

* Lens for Art. 1507 is clear

Art. 1508 
32,5W LED
Aluminium, 1508AL
Graphite, 1508GR

LED module
- 32,5W LED
- 4050 lumen
- Up to 50 000h
- Warm white, 4000K
- Replaceable light module

* Lens for Art. 1508 is clear

Accessories

Art. 1509
Adapter for 76/60mm
Aluminium, 1509AL
Graphite, 1509GR

* Suitable to use with poles \varnothing 60mm







VISBY

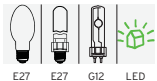

(Lamp head only - for use on 60mm ø poles).
For photometric data contact supplier or log on to www.norlys.com

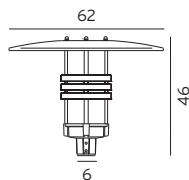

VISBY

IP65, class I
Ideally suited for use in communal areas such as car parks and walkways, Visby is a powder coated aluminium head fitted with a UV resistant polycarbonate lens. For use on posts with 60mm external diameter at top.

Art. 564

Sodium 50W, HSE, E27 / Metal Halide HIE. Aluminium, 564AL Graphite, 564GR White, 564W

Art. 566

Sodium 70W, HSE, E27 / Metal Halide HIE. Aluminium, 566AL Graphite, 566GR White, 566W

Art. 567

Sodium 50-70W, HSE, E27 / Metal Halide HIE. Aluminium, 567AL Graphite, 567GR White, 567W

Art. 569

150W HIT, G12 Aluminium, 569AL Graphite, 569GR White, 569W

Art. 575

70W HIT, G12 Aluminium, 575AL Graphite, 575GR White, 575W

Art. 576

Will be available with LED from **August/September 2014**





NICE



(Lamp head only - for use on 60mm \varnothing poles).
For photometric data contact supplier or log on to www.norlys.com

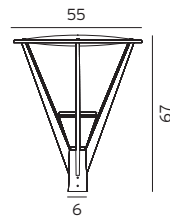

NICE
IP65, class I
Nice are ideally suited for use in communal areas such as carparks and walkways.
Powder coated aluminium head. For use on posts with 60mm external diameter at top.

Art. 770
HIT 70W CDM-T, G12
Aluminium, 770AL
Graphite, 770GR
White, 770W

Art. 772
HIT 150W CDM-T, G12
Aluminium, 772AL
Graphite, 772GR
White, 772W

Art. 774
HIT 35W CDM-T, G12
Aluminium, 774AL
Graphite, 774GR
White, 774W



TELESCOPIC POLE

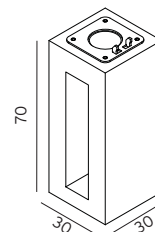
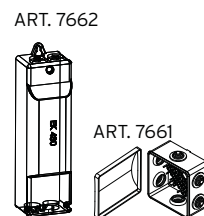
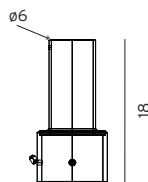
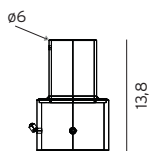
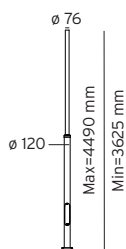
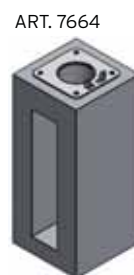
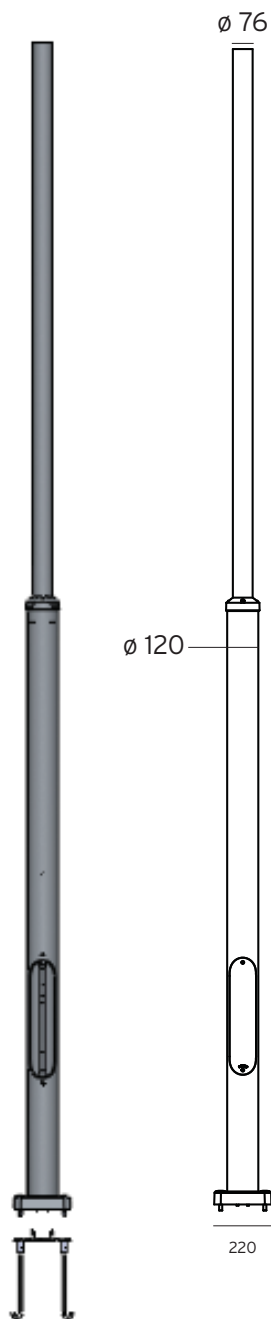

POLE
 Ideally suited for use in communal areas such as car parks and walkways. The pole is telescopic and can be adjusted from :
 min= 3625mm to max=4490mm
 Top tube \varnothing 76mm
 Pole for use with products VISBY, SUNNFJORD, NICE AND KOSTER.
 Adapter in fuction to product neassary.
 See Art. 7660 and 7665

Art. 3005
 Included service door + anchors

Art. 3006
 Included service door + anchors + art 7661

Art. 3007
 Included service door + anchors + Art 7662, EK 480

Accessories Art. 7660
 Adapter for 76/60mm (short version)

* Suitable to use with **VISBY** head \varnothing 60mm and **KOSTER Art. 727 and 729**

Accessories Art. 7665
 Adapter for 76/60mm (long version)

* Suitable to use with **NICE** head \varnothing 60mm

Accessories Art. 7661
 Electric box for pole 3006

Art. 7662
 Electric box for pole 3007 (EK 480 GIS-2D)

Accessories Art. 7664
 Concrete base for pole 3005-3007 (100kg)



KOSTER



LED G24q-3

For photometric data contact supplier or log on to www.norlys.com

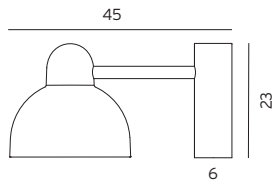

KOSTER LAMP HEAD

For use on posts with 60mm external diameter at top. Ideally suited for use in communal areas such as car parks and walkways, Koster is a powder coated aluminium head supplied with optical structure polycarbonate lens.

IP54, Class I

Art. 727

26W, G24q-3, HF Aluminium, 727AL Graphite, 727GR White, 727W

(Lamp head only - for use on 60mm ø poles).

Art. 729

16W LED  class I. Aluminium, 729AL Graphite, 729GR White, 729W

LED version
 - 16W LED
 - 1100 lumen
 - Up to 50000h
 - Warm white, 3000K
 - Replaceable light module

KOSTER TELESCOPIC POLE

Ideally suited for use in communal areas such as car parks and walkways, Koster is a powder coated aluminium head supplied with optical structure polycarbonate lens.

IP54, class I

Accessories

Art. 405
 Concreting anchor for Art. 1272
Art. 406
 Anchoring support for Art. 1272

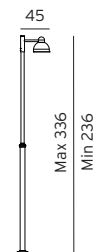

Art. 1272

16W LED  class I. Aluminium, 1272AL Graphite, 1272GR White, 1272W

LED version
 - 16W LED
 - 1100 lumen
 - Up to 50000h
 - Warm white, 3000K
 - Replaceable light module

* See also poles for use with Koster ø60mm Art. 727 and 729 on p.12





KOSTER



E27 G24q-3 LED

For photometric data contact supplier or log on to www.norlys.com

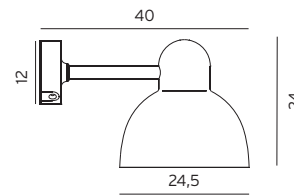
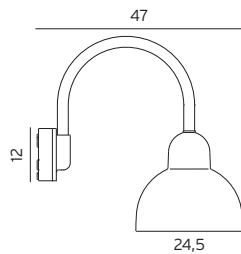

KOSTER

Powder coated aluminium wall light supplied with optical structure polycarbonate lens.

IP54

Accessories

Art. 158
Corner bracket for art Koster wall models.
Aluminium, 158AL
Graphite, 158GR
White, 158W

Art. 720

70W Halo. max, class II.
Aluminium, 720AL
Graphite, 720GR
White, 720W

Art. 723

26W, G24q-3, HF, class I.
Aluminium, 723AL
Graphite, 723GR
White, 723W

Art. 721

16W LED 
class I.
Aluminium, 721AL
Graphite, 721GR
White, 721W

LED version
- 16W LED
- 1100 lumen
- Up to 50000h
- Warm white, 3000K
- Replaceable light module

Art. 724

70W Halo. max, class I.
Aluminium, 724AL
Graphite, 724GR
White, 724W

Art. 728

26W, G24q-3, HF, class I
Aluminium, 728AL
Graphite, 728GR
White, 728W

Art. 725

16W LED 
class I.
Aluminium, 725AL
Graphite, 725GR
White, 725W

LED version
- 16W LED
- 1100 lumen
- Up to 50000h
- Warm white, 3000K
- Replaceable light module





STAVANGER

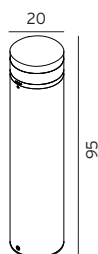

STAVANGER
IP65, class I
Powder coated aluminium bollard.
Lens: stabilised polycarbonate,
vandal resistant.
Indirect LED light output.

Accessories for Stavanger bollards

Art. 1230
Concreting anchor for Stavanger range.
Art. 1231
Anchoring support for Stavanger range.

Art. 1240 
14,7W LED
Aluminium, 1240AL
Graphite, 1240GR

LED version
- 14,7W LED
- 1380 lumen
- Up to 50000h
- Warm white, 3000K
- Replaceable light module

Art. 1241
35W, G12, HIT
Aluminium, 1241AL
Graphite, 1241GR

Art. 1242
70W, G12, HIT
Aluminium, 1242AL
Graphite, 1242GR

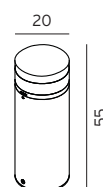

Art. 1244 
14,7W LED
Aluminium, 1244AL
Graphite, 1244GR

LED version
- 14,7W LED
- 1380 lumen
- Up to 50000h
- Warm white, 3000K
- Replaceable light module

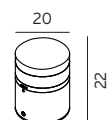

Art. 1245 
7W LED
Aluminium, 1245AL
Graphite, 1245GR

LED version
- 7W LED
- 750 lumen
- Up to 50000h
- Warm white, 3000K
- Replaceable light module

Art. 1247 
7W LED
Aluminium, 1247AL
Graphite, 1247GR

LED version
- 7W LED
- 750 lumen
- Up to 50000h
- Warm white, 3000K
- Replaceable light module



FILIPSTAD BRYGGE 1

NARVIK

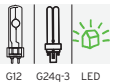

G12 G24q-3 LED



For photometric data contact supplier
or log on to www.norlys.com

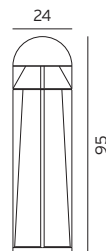

NARVIK

IP65, class I
Heavy duty bollard.
Powder coated aluminium
bollard. Glare free with
indirect light effect on
internal conical tube. Lens
stabilised
polycarbonate, vandal
resistant.

Concreting anchor:
included.

Art. 552

HIT 35W, G12
Aluminium, 552AL
Graphite, 552GR
White, 552W

Art. 556

26W, G24q-3, HF
Aluminium, 556AL
Graphite, 556GR
White, 556W

Art. 557

28W LED 
Aluminium, 557AL
Graphite, 557GR
White, 557W

LED version
- 28W LED
- 3000 lumen
- Up to 50000h
- Warm white, 3000K
- Replaceable light module

Art. 558

HIT 70W, G12
Aluminium, 558AL
Graphite, 558GR
White, 558W

*For use with Dali
systems.



SANDE



GU10 LED LED

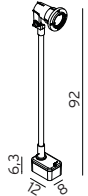
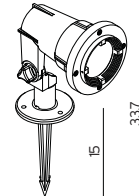
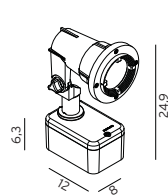

SANDE series IP65, class I

Landscape and shop lighting fixture in aluminium.

Adjustable head for tilting.

- Info LED version with 
- 4W, LED, GU10
 - 250 lumen
 - Up to 40000h
 - Dimmable
 - Warm white, 3000K
 - Replaceable light source

- Info LED version with 
- 7W LED
 - 750 lumen
 - Up to 50000h
 - Warm white, 3000K
 - Replaceable light module

Art. 1590
(Wall, short arm)
4W, LED, GU10, 40D
Graphite, 1590GR

Art. 1591
(Wall, short arm)
7W, LED
Graphite, 1591GR

Art. 1592
(With 5m cable and plug incl. spike)
4W, LED, GU10
Graphite, 1592GR

Art. 1593
(With 5m cable and plug incl. spike)
7W, LED
Graphite, 1593GR

Art. 1595
(Wall, long arm)
7W, LED
Graphite, 1595GR

**For use as wall application
remove spike**



SANDE



GU10 LED

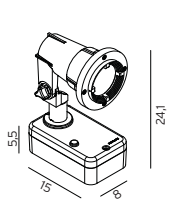

Art. 1594
(Ground, short arm)
7W, LED
Graphite, 1594GR

Accessories
Art. 1234

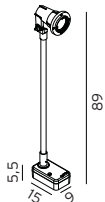

Art. 1596
(Ground, long arm)
7W, LED
Graphite, 1596GR

Accessories
Art. 1234

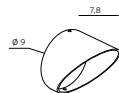

Accessories
Art. 1233
Cap

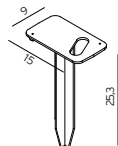

Accessories
Art. 1234
Spike for:
Art. 1594
Art. 1596

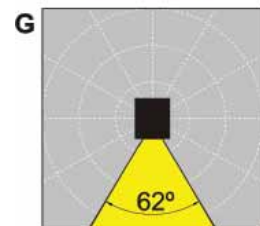
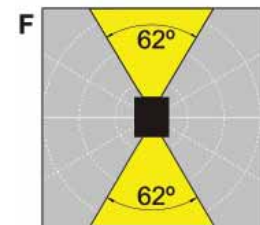
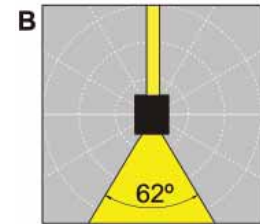
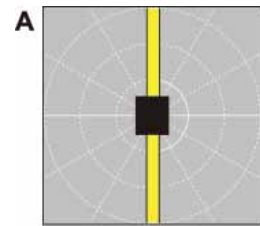

VOSS



G12

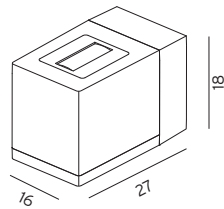

VOSS

IP 54, Class I

Die cast aluminium up and down wall light.

Other varying beam angles and socket (E27) available by special order. Log on to www.norlys.com or please contact supplier.

ART. 780 (version. B)

70W HIT, G12
Aluminium, 780AL
Graphite, 780GR

ART. 783 (version. A)

70W HIT, G12
Aluminium, 783AL
Graphite, 783GR

ART. 784 (version. F)

70W HIT, G12
Aluminium, 784AL
Graphite, 784GR

ART. 785 (version. G)

70W HIT, G12
Aluminium, 785AL
Graphite, 785GR

ART. 786 (version. B)

35W HIT, G12
Aluminium, 786AL
Graphite, 786GR

ART. 787 (version. A)

35W HIT, G12
Aluminium, 787AL
Graphite, 787GR

ART. 788 (version. F)

35W HIT, G12
Aluminium, 788AL
Graphite, 788GR

ART. 789 (version. G)

35W HIT, G12
Aluminium, 789AL
Graphite, 789GR





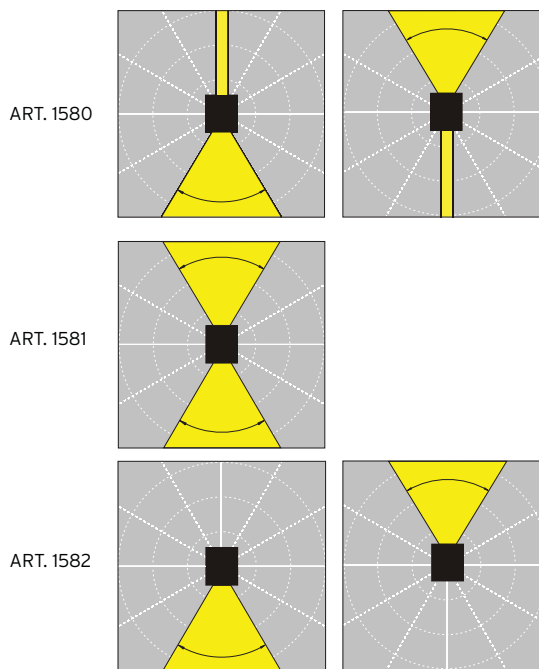

LILLEHAMMER

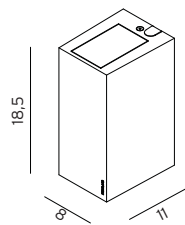

Lillehammer
IP 65, Class I

Die cast aluminium.
Clear glass.
Art 1580 and 1582
can be turned both
ways.

Art. 1580

2x3W LED 
Aluminium, 1580AL
Graphite, 1580GR
White, 1580W

LED version
- 2x3W LED
- 2x250 lumen
- Up to 50000h
- Warm white, 3000K
- Replaceable light module

Art. 1581

2x3W LED 
Aluminium, 1581AL
Graphite, 1581GR
White, 1581W

LED version
- 2x3W LED
- 250 lumen
- Up to 50000h
- Warm white, 3000K
- Replaceable light module

Art. 1582

3W LED 
Aluminium, 1582AL
Graphite, 1582GR
White, 1582W

LED version
- 3W LED
- 250 lumen
- Up to 50000h
- Warm white, 3000K
- Replaceable light module



HELSINKI



KIRUNA



Heavy duty anti vandal fixture.
For photometric data contact supplier or log on to www.norlys.com

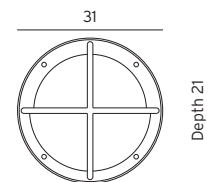
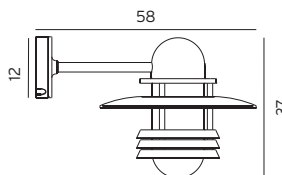
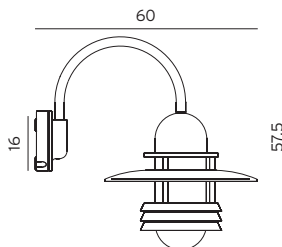

HELSINKI

IP 54
Powder coated aluminium wall light.
Available in a bent or straight arm option.
Supplied with clear polycarbonate lens.

ART. 882

70W Halo. max, E27, class II
Aluminium, 882AL
Graphite, 882GR
White, 882W

ART. 883

26W, G24q-3, HF, class I
Aluminium, 883AL
Graphite, 883GR
White, 883W

Accessories

Art. 156

Corner bracket for art 882 and 883.
Aluminium, 156AL
Graphite, 156GR
White, 156W

ART. 886

70W Halo. max, class I
Aluminium, 886AL
Graphite, 886GR
White, 886W

ART. 887

26W, G24q-3, HF, class I
Aluminium, 887AL
Graphite, 887GR
White, 887W

Accessories

Art. 158

Corner bracket for art 886 and 887.
Aluminium, 158AL
Graphite, 158GR
White, 158W

KIRUNA

IP 66, class II

Powder coated aluminium fixture supplied with a 4mm anti vandal, opal or clear polycarbonate lens.

Art. 595, 596
opal lens.

Options also available with clear glass, contact your supplier.

Art. 595

26W, G24q-3, HF
Aluminium, 595AL
Graphite, 595GR

Art. 596

30W LED 
Aluminium, 596AL
Graphite, 596GR

LED version

- 30W LED
- 2000 lumen
- Up to 50000h
- Warm white, 3000K
- Replaceable light module



GRIMSTAD



G24d-2 LED

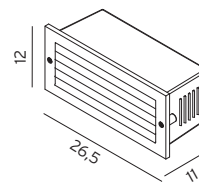
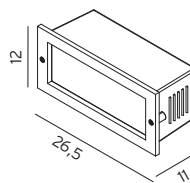

GRIMSTAD
IP 65, class I
Recessed wall lighting
fixture incl. recessing
box.

Art. 1540
Open frame, white
tempered safety glass.
18W, G24d-2
Aluminium, 1540AL
Graphite, 1540GR

Art. 1541
Louvered frame, white
tempered safety glass.
18W, G24d-2
Aluminium, 1541AL
Graphite, 1541GR

Art. 1544 
Aluminium, 1544AL
Graphite, 1544GR
- 8,7W LED
- 505 lumen
- 3000° K
- Up to 49000h
- Replaceable module

Art. 1545 
Aluminium, 1545AL
Graphite, 1545GR
- 8,7W LED
- 630 lumen
- 3000° K
- Up to 49000h
- Replaceable module







RENA



GU10 LED

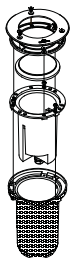

RENA
IP 68, class I
Cast aluminium inground lighting fixture.
Tempered safety glass (max. 2000Kg) , stainless steel 316L cover ring.

3m connecting cable included. (PG in stainless steel for cable 8-12mm)
Polypropylene box for installation included.

Info 5,5W, GU 10 LED
- 5,5W LED, included
- 350 lumen
- Up to 40000h
- Warm white, 2700K
- Replaceable light source

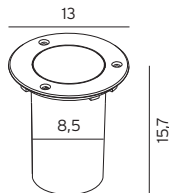

Art. 1550 
Round model
Clear glass
5,5W LED, GU 10
Stainless steel, 1550ST

Art. 1552
Round model
6W max., GU 10
Clear glass
Stainless steel, 1552ST

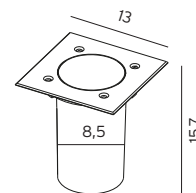

Art. 1554 
Round model
5,5W LED, GU 10
Frosted glass
Stainless steel, 1554ST

Art. 1556
Round model
6W max., GU 10
Frosted glass
Stainless steel, 1556ST

Art. 1551 
Square model
Clear glass
5,5W LED, GU 10
Stainless steel, 1551ST

Art. 1553
Square model
6W max., GU 10
Clear glass
Stainless steel, 1553ST

Art. 1555 
Square model
Frosted glass
5,5W LED, GU 10
Stainless steel, 1555ST

Art. 1557
Square model
6W max., GU 10
Frosted glass
Stainless steel, 1557ST



ASKER



E27 G24q-2 LED

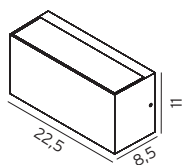

ASKER

IP 65, class I.
Cast aluminium powder coated wall light. Supplied with polycarbonate lens

* For best light distribution we recommend version with LED or 18W.

LED Module

- 8,7W LED 
- 630 lumen
- Up to 49000h
- Warm white, 3000K
- Replaceable LED module



Art.1510

8,7W LED 
Aluminium, 1510AL
Graphite, 1510GR
White, 1510W

Art.1513

E27, 42W Halo. max.
Aluminium, 1513AL
Graphite, 1513GR
White, 1513W

Art.1516

18W, G24q-2, HF
Aluminium, 1516AL
Graphite, 1516GR
White, 1516W



Art.1511

8,7W LED 
Aluminium, 1511AL
Graphite, 1511GR
White, 1511W

Art.1514

E27, 42W Halo. max.
Aluminium, 1514AL
Graphite, 1514GR
White, 1514W

Art.1517

18W, G24q-2, HF
Aluminium, 1517AL
Graphite, 1517GR
White, 1517W



Art.1512

8,7W LED 
Aluminium, 1512AL
Graphite, 1512GR
White, 1512W

Art.1515

E27, 42W Halo. max.
Aluminium, 1515AL
Graphite, 1515GR
White, 1515W

Art.1518

18W, G24q-2, HF
Aluminium, 1518AL
Graphite, 1518GR
White, 1518W





GENEVE

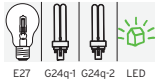

E27 G24q-1 G24q-2 LED

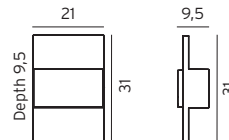
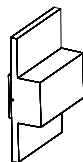

GENEVE

IP 54, class I

Cast aluminium powder coated up and down wall light, supplied with opal polycarbonate lens.

* For best light distribution we recommend version with LED, 13W or 18W.

ART. 874

E27, 28W Halo. max Aluminium, 874AL Graphite, 874GR White, 874W

ART. 876

13W, G24q-1, HF Aluminium, 876AL Graphite, 876GR White, 876W

ART. 877

18W, G24q-2, HF Aluminium, 877AL Graphite, 877GR White, 877W

Art. 879

8,7W LED  Aluminium, 879AL Graphite, 879GR White, 879W

LED module

- 8,7W LED
- 630 lumen
- Up to 49000h
- Warm white, 3000K
- Replaceable LED module







SANDVIK



GU10 GU10
LED LED

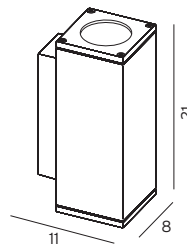

SANDVIK
IP 65, class I
Powder coated
aluminium.
Tempered glass.

ART. 791
2x20W max, GU 10
Aluminium, 791AL
Graphite, 791GR
White, 791W

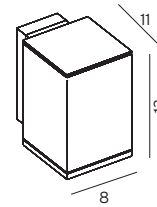

ART. 793
20W max, GU 10
Aluminium, 793AL
Graphite, 793GR
White, 793W

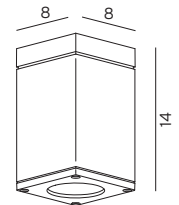

ART. 795
20W max, GU 10
Aluminium, 795AL
Graphite, 795GR
White, 795W

ART. 792
2x4W, LED, GU 10 
Aluminium, 792AL
Graphite, 792GR
White, 792W

(LED bulb from Philips is
included on Art. 792).
Art. 791 and 792
Up and down wall light

ART. 794
4W, LED, GU 10 
Aluminium, 794AL
Graphite, 794GR
White, 794W

(LED bulb from Philips is
included on Art. 794).
Art. 793 and 794
Down wall light

ART. 796
4W, LED, GU 10 
Aluminium, 796AL
Graphite, 796GR
White, 796W

(LED bulb from Philips is
included on Art. 796).
Art. 795 and 796
Down ceiling light.



VASA

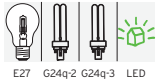

E27 G24q-2 G24q-3 LED

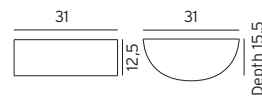

VASA
IP65, class I

Powder coated cast aluminium up and down wall light. Supplied with optical structure polycarbonate lens to give even light distribution.

Available on request:
Special finish in
Black Copper.

Art. 120
E27, 53W Halo. max
Aluminium, 120AL
Graphite, 120GR
White, 120W

Art. 123
18W, G24q-2, HF
Aluminium, 123AL
Graphite, 123GR
White, 123W

Art. 126
26W, G24q-3, HF
Aluminium, 126AL
Graphite, 126GR
White, 126W

Art. 127 
12W LED
Aluminium, 127AL
Graphite, 127GR
White, 127W

LED light source
- 12W, E27 LED included
- 806 lumen
- Dimmable
- 25000 hours
- Warm white, 2700K
- Replaceable light source.

Art. 128 
2x8,7W LED
Aluminium, 128AL
Graphite, 128GR
White, 128W

LED Module
- 2x8,7W LED
- 2x630 lumen
- Up to 49000h
- Warm white, 3000K
- Replaceable light module.







HALDEN



E27 G24q-2 G24q-3 LED

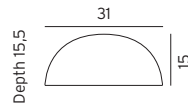

HALDEN

IP65, class I
Powder coated cast aluminium wall light. Supplied with optical structure polycarbonate lens to give even light distribution.

Available on request:
Special finish in Black Copper.

Art. 510

E27, 53W Halo. max
Aluminium, 510AL
Graphite, 510GR
White, 510W

Art. 516

18W, G24q-2, HF
Aluminium, 516AL
Graphite, 516GR
White, 516W

Art. 518

26W, G24q-3, HF
Aluminium, 518AL
Graphite, 518GR
White, 518W

Art. 517

13W LED
Aluminium, 517AL
Graphite, 517GR
White, 517W

LED Module
- 13W LED
- 940 lumen
- Up to 39000h
- Warm white, 3000K
- Replaceable light module.



Art. 519

8,7W LED
Aluminium, 519AL
Graphite, 519GR
White, 519W

LED Module
- 8,7W LED
- 630 lumen
- Up to 49000h
- Warm white, 3000K
- Replaceable light module.





RONDANE

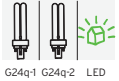

G24q-1 G24q-2 LED

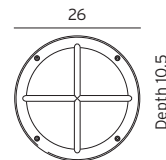

RONDANE IP65, class I

Powder coated aluminium wall light supplied with polycarbonate lens.
Rondane is suitable for wall and ceiling mounting.

Art. 530
13W, G24q-1, HF
Aluminium, 530AL
Graphite, 530GR
White, 530W

Art. 531
18W, G24q-2, HF
Aluminium, 531AL
Graphite, 531GR
White, 531W

Art. 536 
8,7W LED
Aluminium, 536AL
Graphite, 536GR
White, 536W

LED Module
- 8,7W LED
- 630 lumen
- Up to 49000h
- Warm white, 3000K
- Replaceable light module.

Art. 537 
13W LED
Aluminium, 537AL
Graphite, 537GR
White, 537W

LED Module
- 13W LED
- 940 lumen
- Up to 39000h
- Warm white, 3000K
- Replaceable light module.







BORNHOLM



G24q-1 G24q-2 G24q-3 LED

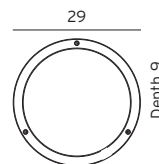

BORNHOLM IP65, class I

Powder coated aluminium wall light supplied with polycarbonate lens. Bornholm is suitable for wall and ceiling mounting.

Art. 532
13W, G24q-1, HF
Aluminium, 532AL
Graphite, 532GR
White, 532W

Art. 533
18W, G24q-2, HF
Aluminium, 533AL
Graphite, 533GR
White, 533W

Art. 534
26W, G24q-3, HF
Aluminium, 534AL
Graphite, 534GR
White, 534W

Art. 540 
8,7W LED
Aluminium, 540AL
Graphite, 540GR
White, 540W

LED Module
- 8,7W LED
- 630 lumen
- Up to 49000h
- Warm white, 3000K
- Replaceable light module.

Art. 541 
13W LED
Aluminium, 541AL
Graphite, 541GR
White, 541W

LED Module
- 13W LED
- 940 lumen
- Up to 39000h
- Warm white, 3000K
- Replaceable light module.



BERN



E27 G24q-1 LED

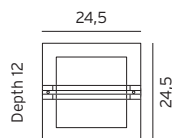

BERN IP54, class I

Wallplate in aluminium. Front in galvanised steel, stainless steel, powder coated black steel or copper. Massive copper reveals a nice and natural patina with age. Heavy clear or frosted glass. We use stainless steel 316L. An oil application from time to time insures long time beauty of the fixture.

Art. 650
E27, 42W Halo. max clear glass
Stainless steel, 650ST
Galvanised, 650GA
Black, 650B

Art. 651
E27, 42W Halo. max frosted glass
Stainless steel, 651ST
Galvanised, 651GA
Black, 651B
Copper, 651CO

Art. 653
13W, G24q-1, HF frosted glass
Stainless steel, 653ST
Galvanised, 653GA
Black, 653B

Art. 655 
8,7W LED
frosted glass
Stainless steel, 655ST
Galvanised, 655GA
Black, 655B

LED Module
- 8,7W LED
- 505 lumen
- Up to 49000h
- Warm white, 3000K
- Replaceable light module.

Art. 656 
13W LED
frosted glass
Stainless steel, 656ST
Galvanised, 656GA
Black, 656B

LED Module
- 13W LED
- 1010 lumen
- Up to 39000h
- Warm white, 3000K
- Replaceable light module.







BASEL

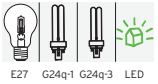

E27 G24q-1 G24q-3 LED

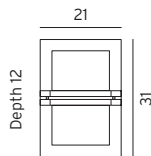

BASEL

IP54, class I

Wallplate in aluminium. Front in galvanised steel, stainless steel, powder coated black steel or copper.

Massive copper reveals a nice and natural patina with age. Heavy clear or frosted glass. We use stainless steel 316L. An oil application from time to time insures long time beauty of the fixture.

Art. 660
E27, 53W Halo. max clear glass
Stainless steel, 660ST
Galvanised, 660GA
Black, 660B

Art. 661 *
E27, 53W Halo. max frosted glass
Stainless steel, 661ST
Galvanised, 661GA
Black, 661B
Copper, 661CO

Art. 663
13W, G24q-1, HF frosted glass
Stainless steel, 663ST
Galvanised, 663GA
Black, 663B

Art. 664
26W, G24q-3, HF frosted glass
Stainless steel, 664ST
Galvanised, 664GA
Black, 664B

Art. 668 
8,7W LED
frosted glass
Stainless steel, 668ST
Galvanised, 668GA
Black, 668B

LED Module
- 8,7W LED
- 505 lumen
- Up to 49000h
- Warm white, 3000K
- Replaceable light module.

Art. 669 
13W LED
frosted glass
Stainless steel, 669ST
Galvanised, 669GA
Black, 669B

LED Module
- 13W LED
- 1010 lumen
- Up to 39000h
- Warm white, 3000K
- Replaceable light module.

* Also available (upon request) models with motion detectors.

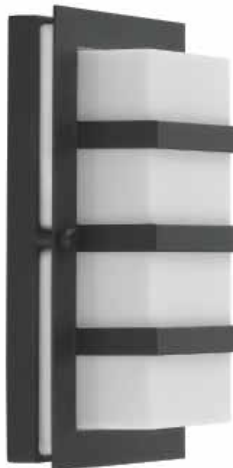

BODÉN



E27 G24q-1 G24q-2 LED

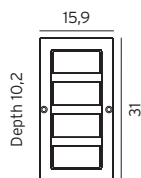

BODÉN
IP54, class I.
Bodén is available in galvanised and black painted steel. Backplate in cast aluminium.

Art. 860, 863, 864, 866 and 867: Opal polycarbonate

Art. 862: Clear polycarbonate

Art.860
E27, 42W Halo. max
Galvanised steel, 860GA
Black, 860B

Art.862
E27, 42W Halo. max
Galvanised steel, 862GA
Black, 862B

Art.863
13W, G24q-1, HF
Galvanised steel, 863GA
Black, 863B

Art.864
18W, G24q-2, HF
Galvanised steel, 864GA
Black, 864B

Art. 866 
8,7W LED
Galvanised, 866GA
Black, 866B

LED Module
- 8,7W LED
- 505 lumen
- Up to 49000h
- Warm white, 3000K
- Replaceable light module.

Art. 867 
13W LED
Galvanised, 867GA
Black, 867B

LED Module
- 13W LED
- 1010 lumen
- Up to 39000h
- Warm white, 3000K
- Replaceable light module.



148





NORDLAND

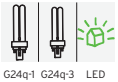

G24q-1 G24q-3 LED

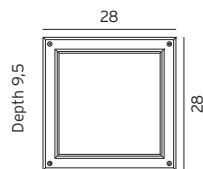

NORDLAND
IP65, class I
Powder coated aluminium
wall light supplied with
opal polycarbonate lens.

Nordland is suitable
for wall and ceiling
mounting.

Art. 711
13W, G24q-1, HF
Aluminium, 711AL
Graphite, 711GR
White, 711W

Art. 713
2x13W, G24q-1, HF
Aluminium, 713AL
Graphite, 713GR
White, 713W

Art. 714
26W, G24q-3, HF
Aluminium, 714AL
Graphite, 714GR
White, 714W

Art. 715
2x26W, G24q-3, HF
Aluminium, 715AL
Graphite, 715GR
White, 715W

Art. 718 
13W LED
Aluminium, 718AL
Graphite, 718GR
White, 718W

LED Module
- 13W LED
- 1010 lumen
- Up to 39000h
- Warm white, 3000K
- Replaceable light
module.

Art. 719 
17,5W LED
Aluminium, 719AL
Graphite, 719GR
White, 719W

LED Module
- 17,5W LED
- 1550 lumen
- Up to 47000h
- Warm white, 3000K
- Replaceable light
module.



NORDKAPP

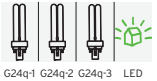

G24q-1 G24q-2 G24q-3 LED

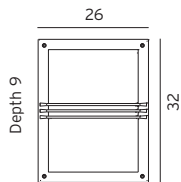

NORDKAPP

IP65, class I
Powder coated aluminium
wall light supplied with
opal polycarbonate lens.

Nordkapp is suitable
for wall and ceiling
mounting.

Art. 527

18W, G24q-2, HF
Aluminium, 527AL
Graphite, 527GR
White, 527W

Art.528

13W, G24q-1, HF
Aluminium, 528AL
Graphite, 528GR
White, 528W

Art.529

2x13W, G24q-1, HF
Aluminium, 529AL
Graphite, 529GR
White, 529W

Art.1490

2x26W, G24q-3, HF
Aluminium, 1490AL
Graphite, 1490GR
White, 1490W

Art. 1620

8,7W LED 
Aluminium, 1620AL
Graphite, 1620GR
White, 1620W

LED Module

- 8,7W LED
- 630 lumen
- Up to 49000h
- Warm white, 3000K
- Replaceable light module.

Art. 1621

17,5W LED 
Aluminium, 1621AL
Graphite, 1621GR
White, 1621W

LED Module

- 17,5W LED
- 1550 lumen
- Up to 47000h
- Warm white, 3000K
- Replaceable light module.





ARENDA WALL



ARENDA L

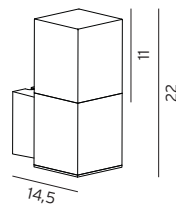

Arendal wall
IP65, class II

Powder coated aluminium wall light, supplied with tempered glass, frosted inside.

Art. 1250
E14, 46W. max
Black 1250B

Arendal bollards
IP65, class II

Galvanised steel or painted steel bollards. Tempered glass, frosted inside.



Art. 1560
E27, 42W Halo. max
Galvanised, 1560GA
Black 1560B

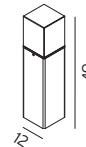

Art. 1565
E27, 42W Halo. max
Galvanised, 1565GA
Black 1565B

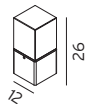

Art. 1569
E27, 42W Halo. max
Galvanised, 1569GA
Black 1569B

Accessories

Art. 205

Concreting anchor for Art. 1560, 1565 and 1569

Art. 206

Anchoring support for Art. 1560, 1565 and 1569

HALMSTAD

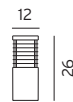
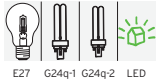

Art. 210
E27, 42W Halo. max
Galvanised, 210GA
Black, 210B 60



Art. 295
E27, 42W Halo. max
Galvanised, 295GA 60
Black, 295B 60



Art. 296
E27, 42W Halo. max
Galvanised, 296GA 60
Black, 296B 60

HALMSTAD
IP65, class II.
Galvanised heavy duty steel bollard supplied with opal polycarbonate lens.
Available on request:
Special finish in Black Copper.

Accessories
Art. 205
Concreting anchor for Art. Halmstad range.
Art. 206
Anchoring support for Art. Halmstad range.

Art. 1485
13W, G24q-1, HF
Galvanised, 1485GA
Black, 1485B

Art. 1486
18W, G24q-2, HF
Galvanised, 1486GA
Black 1486B

Art. 1480
13W, G24q-1, HF
Galvanised, 1480GA
Black, 1480B

Art. 1481
18W, G24q-2, HF
Galvanised, 1481GA
Black, 1481B

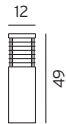

HALMSTAD WITH LED
IP65
Bollards with LED: class I

Galvanised heavy duty steel bollard supplied with opal polycarbonate lens.

Available on request:
Special finish in Black Copper.

Accessories

Art. 205

Concreting anchor for Art. Halmstad range.

Art. 206

Anchoring support for Art. Halmstad range.

Art. 1489 
7W LED
Galvanised, 1489GA
Black 1489B

LED Module
- 7W LED
- 750 lumen
- Up to 50000h
- Warm white, 3000K
- Replaceable light module.

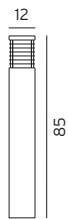

Art. 1482 
7W LED
Galvanised, 1482GA
Black 1482B

LED Module
- 7W LED
- 750 lumen
- Up to 50000h
- Warm white, 3000K
- Replaceable light module.



Art. 1487 
14,7W LED
Galvanised, 1487GA
Black 1487B

LED Module
- 14,7W LED
- 1380 lumen
- Up to 50000h
- Warm white, 3000K
- Replaceable light module.



SCANDINAVIAN WOOD



Our new range of wooden bollards fits perfectly to all projects combining modern lighting in harmony with natural materials.
 We use a selection of first class Scandinavian pine wood, impregnated for protection.
 Easy maintenance: painted twice during production, refresh the surface with oil paint.
Special marked with *:
 Impregnated only: without painting on request to allow customized colours.

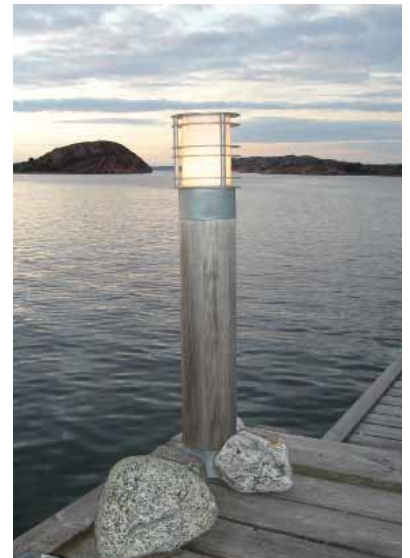

HALMSTAD



STOCKHOLM



ALTA

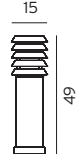
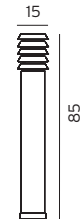
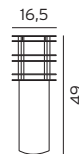
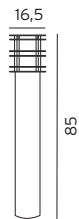
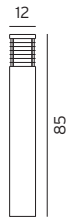
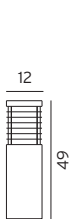

Scandinavian Wood
 IP65, class II,

Accessories for Scandinavian wood.

Art. 205
 Concreting anchor for wood series.
Art. 206
 Anchoring support for wood series.

Art. 1400
 E27, 42W Halo. max Galvanised, 1400GA Black, 1400B
Art. 1401
 13W, G24q-1, HF Galvanised, 1401GA Black, 1401B
Art. 1402
 18W, G24q-2, HF Galvanised, 1402GA Black, 1402B
Art. 1403 *
 E27, 42W Halo. max Galvanised, 1403GA Black, 1403B

Art. 1410
 E27, 42W Halo. max Galvanised, 1410GA Black 1410B
Art. 1411
 13W, G24q-1, HF Galvanised, 1411GA Black, 1411B
Art. 1412
 18W, G24q-2, HF Galvanised, 1412GA Black, 1412B
Art. 1413 *
 E27, 42W Halo. max Galvanised, 1413GA Black, 1413B

Art. 1420
 E27, 42W Halo. max Galvanised, 1420GA Black 1420B
Art. 1421
 13W, G24q-1, HF Galvanised, 1421GA Black 1421B
Art. 1422
 18W, G24q-2, HF Galvanised, 1422GA Black 1422B
Art. 1423 *
 E27, 42W Halo. max Galvanised, 1423GA Black, 1423B

Art. 1430
 E27, 42W Halo. max Galvanised, 1430GA Black 1430B
Art. 1431
 13W, G24q-1, HF Galvanised, 1431GA Black 1431B
Art. 1432
 18W, G24q-2, HF Galvanised, 1432GA Black 1432B
Art. 1433 *
 E27, 42W Halo. max Galvanised, 1433GA Black, 1433B

Art. 1440
 E27, 42W Halo. max Galvanised, 1440GA Black 1440B
Art. 1441
 13W, G24q-1, HF Galvanised, 1441GA Black 1441B
Art. 1442
 18W, G24q-2, HF Galvanised, 1442GA Black 1442B
Art. 1443 *
 E27, 42W Halo. max Galvanised, 1443GA Black, 1443B

Art. 1450
 E27, 42W Halo. max Galvanised, 1450GA Black 1450B
Art. 1451
 13W, G24q-1, HF Galvanised, 1451GA Black 1451B
Art. 1452
 18W, G24q-2, HF Galvanised, 1452GA Black 1452B
Art. 1453 *
 E27, 42W Halo. max Galvanised, 1453GA Black, 1453B



ALTA

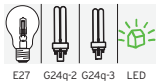

Art. 291
E27, 42W Halo. max
Galvanised, 291GA
Black 291B



Art. 1478
7W LED
Galvanised, 1478GA
Black 1478B



Art. 1479
14,7W LED
Galvanised, 1479GA
Black 1479B

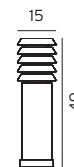

Art. 293
E27, 42W Halo. max
Galvanised, 293GA
Black 293B

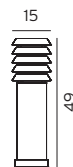

Art. 1476
7W LED
Galvanised, 1476GA
Black 1476B

ALTA
IP65, class II

Bollards with LED: class I 

Galvanised steel bollard supplied with opal polycarbonate lens.

Accessories

- Art. 205**
Concreting anchor for Alta range.
- Art. 206**
Anchoring support for Alta range.

Art. 1470
18W, G24q-2, HF
Galvanised, 1470GA
Black 1470B

Art. 1471
26W, G24q-3, HF
Galvanised, 1471GA
Black 1471B

LED Module
- 7W LED
- 750 lumen
- Up to 50000h
- Warm white, 3000K
- Replaceable light module.

LED Module
- 14,7W LED
- 1380 lumen
- Up to 50000h
- Warm white, 3000K
- Replaceable light module.

Art. 1472
18W, G24q-2, HF
Galvanised, 1472GA
Black 1472B

Art. 1473
26W, G24q-3, HF
Galvanised, 1473GA
Black 1473B

LED Module
- 7W LED
- 750 lumen
- Up to 50000h
- Warm white, 3000K
- Replaceable light module.



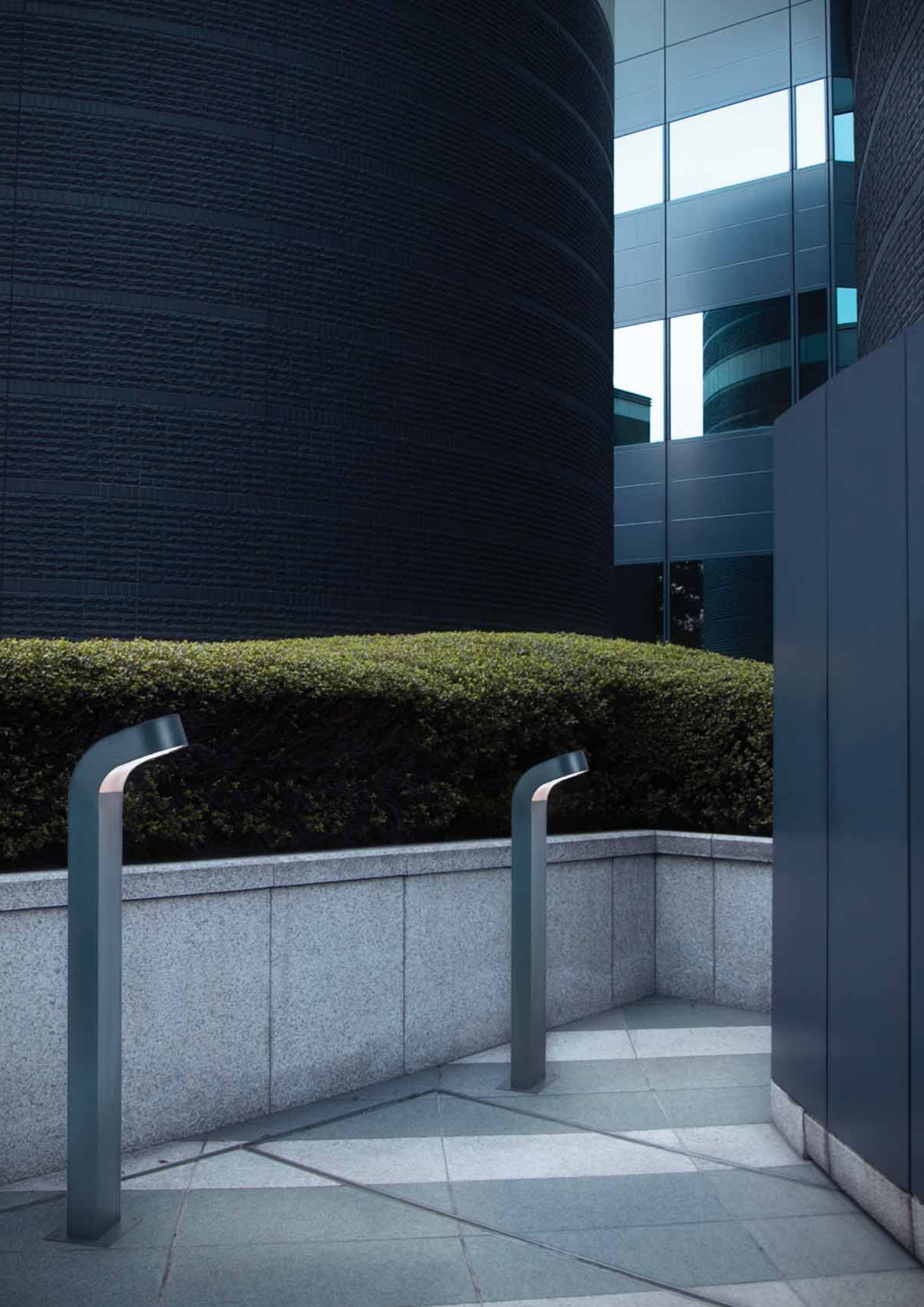

MOLDE



LED



ARVIKA



G12 GX24q-2



Molde
13W LED module
Please see our website for
release date for this model.

ARVIKA
IP54, class I

Arvika can be delivered
with normal jack contacts
automatic fuses and
earth fault.
Contact Norlys directly.
(Art.892, 895 and is
supplied with bulb as standard).

Accessories
Supplied with concrete
anchor kit as standard.

Art. 890
HIT 35W, G12
Galvanised steel, 890GA
Black, 890B
Art. 892
OSRAM DULUX T/E 18W, Gx24 q-2
Galvanised steel, 892GA
Black, 892B
Art. 894 (normal jack contacts)
HIT 35W, G12
Galvanised steel, 894GA
Black, 894B
Art. 895 (normal jack contacts)
OSRAM DULUX T/E 18W, Gx24 q-2
Galvanised steel, 895GA
Black, 895B



STOCKHOLM

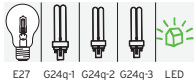

E27 G24q-1 G24q-2 G24q-3 LED



STOCKHOLM BOLLARD

Galvanised steel bollard.
IP65, class II

Bollards with LED : class I 

Available after request in color:

Black Copper. Please specify lamp option (Art No) and finish at time of order.

Accessories

Art. 205
Concreting anchor for Stockholm range.

Art. 206
Anchoring support for Stockholm range.

Art. 288

E27, 42W Halo. max, (Opal).
Galvanised, 288GA 60
Black, 288B 60

Art. 297

E27, 42W Halo. max, (clear).
Galvanised, 297GA
Black, 297B

Art. 1460

13W, G24q-1, HF (Opal).
Galvanised, 1460GA
Black, 1460B

Art. 1461

18W, G24q-2, HF, (Opal).
Galvanised, 1461GA
Black, 1461B

Art. 1462

26W, G24q-3, HF, (Opal).
Galvanised, 1462GA
Black, 1462B

Art. 1265

7W LED, (Opal) 
Galvanised, 1265GA
Black 1265B

LED Module

- 7W LED
- 750 lumen
- Up to 50000h
- Warm white, 3000K
- Replaceable light module.

Art. 1266

14,7W LED, (Opal) 
Galvanised, 1266GA
Black 1266B

LED Module

- 14,7W LED
- 1380 lumen
- Up to 50000h
- Warm white, 3000K
- Replaceable light module.

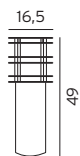

STOCKHOLM BOLLARD

Galvanised steel bollard.
IP65, class II

Bollards with LED : class I 

Available after request in color:
Black Copper. Please specify lamp option
(Art No) and finish at time of order.

Accessories

Art. 205
Concreting anchor for Stockholm range.

Art. 206
Anchoring support for Stockholm range.

Art. 289
E27, 42W Halo. max, (Opal).
Galvanised, 289GA 60
Black, 289B 60

Art. 298
E27, 42W Halo. max, (Clear).
Galvanised, 298GA
Black, 298B

Art. 1465
13W, G24q-1, HF, (Opal).
Galvanised, 1465GA
Black, 1465B

Art. 1466
18W, G24q-2, HF, (Opal).
Galvanised, 1466GA
Black, 1466B

Art. 1467
26W, G24q-3, HF, (Opal).
Galvanised, 1467GA
Black, 1467B

Art. 1260 
7W LED, (Opal)
Galvanised, 1260GA
Black 1260B

LED Module
- 7W LED
- 750 lumen
- Up to 50000h
- Warm white, 3000K
- Replaceable light
module.

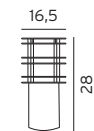

Art. 299
E27, 42W Halo. max, (Opal).
Galvanised, 299GA
Black, 299B





STOCKHOLM

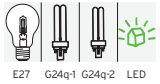

E27 G24q-1 G24q-2 LED

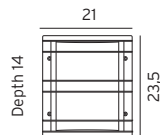

Stockholm flush
IP54, class I

Aluminium back plate. Front detail in powder coated or galvanised steel.

Art. 220, 223, 225, 1600 and 1601: Opal polycarbonate

Art. 226 : Clear polycarbonate

Art. 220
E27, 42W Halo. max. Galvanised, 220GA Black, 220B

Art. 223
13W, G24q-1, HF Galvanised, 223GA Black, 223B

Art. 225
18W, G24q-2, HF Galvanised, 225GA Black, 225B

Art. 226
E27, 42W Halo. max Galvanised, 226GA Black, 226B

Art. 1600 
8,7W LED Galvanised, 1600GA Black, 1600B

LED Module
- 8,7W LED
- 505 lumen
- Up to 49000h
- Warm white, 3000K
- Replaceable light module.

Art. 1601 
13W LED Galvanised, 1601GA Black, 1601B

LED Module
- 13W LED
- 1010 lumen
- Up to 39000h
- Warm white, 3000K
- Replaceable light module.



STOCKHOLM



E27

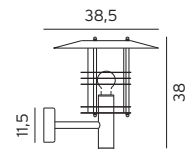
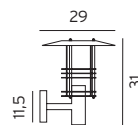

Stockholm
IP54, class II

Supplied with clear polycarbonate lens as standard. Natural copper option will age overtime.

(Opal lens available as an option).

Available on request:
Special finish in Black Copper.

Art. 280
E27, 42W Halo. max. clear polycarbonate.
Galvanised steel, 280GA
Black, 280B
White, 280W
Copper, 280CO

Accessories
Art. 153
Corner bracket for Art. 280.
Galvanised steel, 153GA
Black, 153B
White, 153W
Copper, 153CO

Art. 286
E27, 70W Halo. max. clear polycarbonate.
Galvanised steel, 286GA
Black, 286B
White, 286W

Accessories
Art. 153
Corner bracket for Art. 286.
Galvanised steel, 153GA
Black, 153B
White, 153W





STOCKHOLM



E27

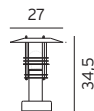

Art. 284
E27, 42W Halo. max.
clear polycarbonate.
Galvanised, 284GA
Black, 284B
White, 284W

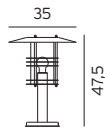

Art. 287
E27, 70W Halo. max.
clear polycarbonate.
Galvanised, 287GA
Black, 287B
White, 287W

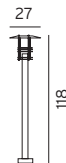

Art. 285
E27, 42W Halo. max.
clear polycarbonate.
Galvanised, 285GA
Black, 285B
White, 285W

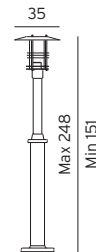

Art. 281
E27, 70W Halo. max.
clear polycarbonate.
Galvanised, 281GA
Black, 281B
White, 281W

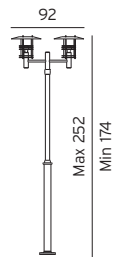

Art. 283
E27, 2x70W Halo. max.
clear polycarbonate.
Galvanised, 283GA
Black, 283B
White, 283W

Stockholm

IP54, class II

Supplied with clear polycarbonate lens as standard.

Opal lens available as accessory.

Available on request:

Special finish in Black Copper.

Accessories

Art. 405 Concreting anchor for Art. 281 and 283.

Art. 406 Anchoring support for Art. 281 and 283.

Concreting anchor included for Art. 284, 287 and 285

Art. 284 round foot, diameter 11,5cm.

Art. 285 and 287 round foot, diameter 17cm.

Art. 281 and 283. Diameter foot 23,5 cm. The distance between bolt holes (3 bolts) for post Art. 281 and 283 is 18 cm.







BREMEN

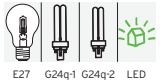

E27 G24q-1 G24q-2 LED

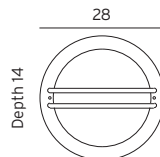

BREMEN

IP54, class I

The front cover is made of steel and mounted on an aluminium backplate.
Option of smoked or opal lens.

Available on request:
Special finish in Black Copper.

Art. 630
E27, 42W Halo. max. clear polycarbonate. Galvanised, 630GA Black, 630B

Art. 631
E27, 42W Halo. max. opal polycarbonate. Galvanised, 631GA Black, 631B

Art. 633
13W, G24q-1, HF, opal polycarbonate. Galvanised, 633GA Black, 633B

Art. 634
18W, G24q-2, HF opal polycarbonate. Galvanised, 634GA Black, 634B

Art. 636 
8,7W LED opal polycarbonate. Galvanised, 636GA Black, 636B

LED Module
- 8,7W LED
- 630 lumen
- Up to 49000h
- Warm white, 3000K
- Replaceable light module.

Art. 637 
13W LED opal polycarbonate. Galvanised, 637GA Black, 637B

LED Module
- 13W LED
- 940 lumen
- Up to 39000h
- Warm white, 3000K
- Replaceable light module.

BERLIN

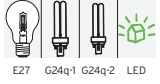

HAMBURG

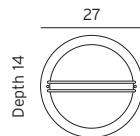
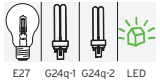

BERLIN IP54, class I

Cast aluminium wall light with clear or opal polycarbonate lens options.

Available on request:
Special finish in Black Copper.

**BERLIN
Art. 610**
E27, 42W Halo. max., clear polycarbonate.
Black, 610B
White, 610W
Aluminium, 610AL

Art. 611
E27, 42W Halo. max., opal polycarbonate.
Black, 611B
White, 611W
Aluminium, 611AL

**BERLIN
Art. 613**
13W, G24q-1, HF, opal polycarbonate.
Black, 613B
White, 613W
Aluminium, 613AL

Art. 614
18W, G24q-2, HF, opal polycarbonate.
Black, 614B
White, 614W
Aluminium, 614AL

**BERLIN
Art. 616** 
8,7W LED
opal polycarbonate.
Black, 616B
White, 616W
Aluminium, 616AL

LED Module
- 8,7W LED
- 630 lumen
- Up to 49000h
- Warm white, 3000K
- Replaceable light module.

**BERLIN
Art. 617** 
13W LED
opal polycarbonate.
Black, 617B
White, 617W
Aluminium, 617AL

LED Module
- 13W LED
- 940 lumen
- Up to 39000h
- Warm white, 3000K
- Replaceable light module.

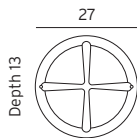

HAMBURG
IP54, class I

Cast aluminium wall light with clear or opal polycarbonate lens options.

Available on request:
Special finish in Black Copper.

HAMBURG
Art. 620

E27, 42W Halo. max., clear polycarbonate.
Black, 620B
White, 620W
Aluminium, 620AL

Art. 621

E27, 42W Halo. max., opal polycarbonate.
Black, 621B
White, 621W
Aluminium, 621AL

HAMBURG
Art. 623

13W, G24q-1, HF, opal polycarbonate.
Black, 623B
White, 623W
Aluminium, 623AL

Art. 624

18W, G24q-2, HF, opal polycarbonate.
Black, 624B
White, 624W
Aluminium, 624AL

HAMBURG
Art. 626



8,7W LED opal polycarbonate.
Black, 626B
White, 626W
Aluminium, 626AL

LED Module
- 8,7W LED
- 630 lumen
- Up to 49000h
- Warm white, 3000K
- Replaceable light module.

HAMBURG
Art. 627



13W LED opal polycarbonate.
Black, 627B
White, 627W
Aluminium, 627AL

LED Module
- 13W LED
- 940 lumen
- Up to 39000h
- Warm white, 3000K
- Replaceable light module.



LUND



E27

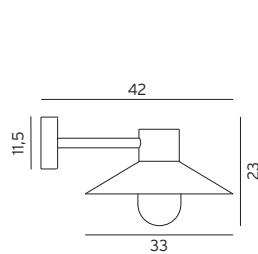

LUND
IP55, Class II,
Clear polycarbonate.

Art. 274, 275, 290
Can be ordered with
frosted glass or clear
polycarbonate as
accessories.

Art. 290
E27, 53W Halo. max.
Galvanised, 290GA
Black, 290B

Accessories
Art. 153
Corner bracket
for Art. 290.
Galvanised steel, 153GA
Black, 153B

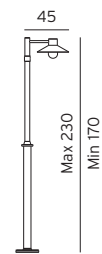

Art. 274
E27, 53W Halo. max.,
Galvanised, 274GA
Black, 274B

Accessories
Art. 405
Concreting anchor
for Art. 274
Art. 406
Anchoring support
for Art. 274

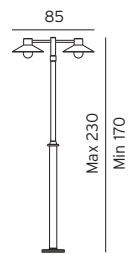

Art. 275
E27, 2x53W Halo. max.
Galvanised, 275GA
Black, 275B

Accessories
Art. 405
Concreting anchor
for Art. 275
Art. 406
Anchoring support
for Art. 275





OSLO

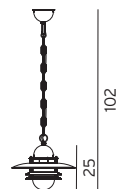
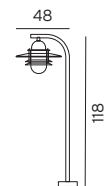
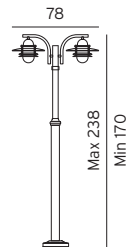
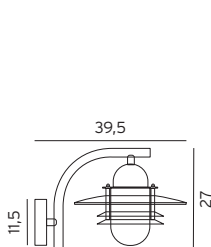

OSLO

IP55, class II
Clear glass

All Oslo models can be ordered with opal glass, frosted glass or clear polycarbonate as accessories.
The copper will age naturally over time.

Available on request:
Special finish in Black Copper.

Art. 240

E27, 53W Halo. max.
Galvanised, 240GA
Black, 240B
White, 240W
Copper, 240CO

Accessories

Art. 153
Corner bracket for Art 240 and 243.
Galvanised, 153GA
Black, 153B
White, 153W
Copper, 153CO

Art. 242

E27, 2x53W Halo. max.
clear glass.
Galvanised, 242GA
Black, 242B
White, 242W

Accessories

Art. 405
Concreting anchor for Art. 242.
Art. 406
Anchoring support for Art. 242

Art. 245

E27, 53W Halo. max.
clear glass
Galvanised, 245GA
Black, 245B
White, 245W

Accessories

Concreting anchor included.

Art. 245 round foot, diameter 17cm.

ART. 240A (chain)

E27, 53W Halo. max.
Galvanised steel, 240A/GA
Black, 240A/B
White, 240A/W
Copper, 240A/CO







PARIS

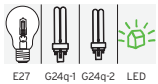

E27 G24q-1 G24q-2 LED

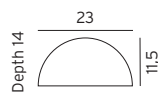

PARIS

IP43, class I

This down light gives a subtle wash of light. Over time the copper will age naturally and acquire an antique brown patina.

Accessories

Art. 168
Number plate for ART. 160-164 by special order. Only black or galvanized.

Art. 160
E27, 28W Halo. max.
Galvanized, 160GA
Black, 160B
White, 160W
Copper, 160CO

Art. 1491
13W, G24q-1, HF
Galvanized, 1491GA
Black, 1491B
White, 1491W
Copper, 1491CO

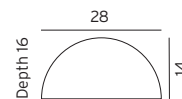

Art. 1495 
8,7W LED
Galvanized, 1495GA
Black, 1495B
White, 1495W

LED Module
- 8,7W LED
- 630 lumen
- Up to 49000h
- Warm white, 3000K
- Replaceable light module.

Art. 163
E27, 42W Halo. max.
Galvanized, 163GA
Black, 163B
White, 163W

Art. 1492
18W, G24q-2, HF
Galvanized, 1492GA
Black, 1492B
White, 1492W

Art. 1496 
8,7W LED
Galvanized, 1496GA
Black, 1496B
White, 1496W

LED Module
- 8,7W LED
- 630 lumen
- Up to 49000h
- Warm white, 3000K
- Replaceable light module.



KARLSTAD



E27

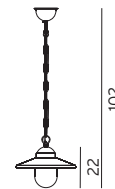
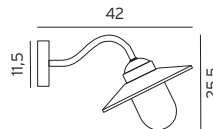

KARLSTAD

IP55, class II
Supplied with clear lens.

Opal, frosted and clear
GLASS options available
to special order as
accessories.

The copper will age
naturally over time.

Available on request:
Special finish in Black
Copper.

Art. 230

E27, 53W Halo. max.
Galvanised, 230GA
Black, 230B
White, 230W
Copper, 230CO

Accessories

Art. 153

Corner bracket for
Art 230.
Galvanised steel, 153GA
Black, 153B
White, 153W
Copper, 153CO

Art. 230A (chain)

E27, 53W Halo. max.
Galvanised, 230A/GA
Black, 230A/B
White, 230A/W
Copper, 230A/CO





BERGEN



BAVARIA

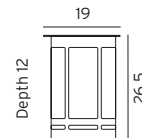
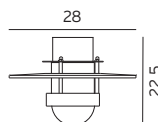
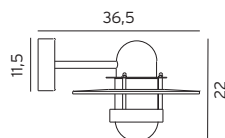

BERGEN
IP55, Class II

Art. 270 and 271
Can be ordered with
frosted glass or clear
polycarbonate as
accessory.

BERGEN
Art. 270
E27, 53W Halo. max.
Clear glass.
Galvanised, 270GA
Black, 270B
White, 270W

Accessories
Art. 153
Corner bracket for
Art 270.
Galvanised steel, 153GA
Black, 153B
White, 153W

BERGEN
Art. 271
E27, 53W Halo. max.
Clear glass.
Galvanised, 271GA
Black, 271B
White, 271W

BAVARIA
IP43, Class II
Aluminium back
plate. Front in
powder coated or
galvanised Steel.

BAVARIA
Art. 680
E27, 42W Halo. max.
Clear polycarbonate.
Galvanised, 680GA
Black, 680B





CHELSEA

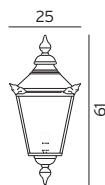

Art. 950
E27, 70W Halo. max.
Copper, 950CO

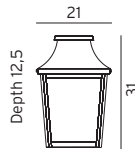

Art. 962
E27, 53W Halo. max.
Copper, 962CO

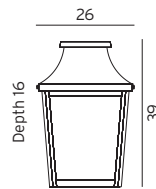

Art. 963
E27, 53W Halo. max.
Copper, 963CO

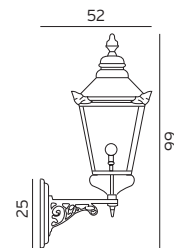

Art. 955
E27, 70W Halo. max.
Copper, 955CO

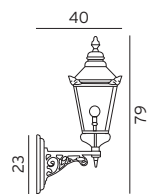

Art. 954
E27, 70W Halo. max.
Copper, 954CO

CHELSEA RANGE
IP44, class II
Fabricated from copper and supplied with clear polycarbonate lens.

Copper fittings are supplied in a raw finish to allow natural patina over time.

Brackets and posts manufactured in aluminium and powder coated in black.

Chelsea range also available with LED module.

Part of Chelsea range is available with LED 
IP 65

Contact your supplier for more information!

Accessories
Art. 152
Corner bracket for Art 954.
Black, 152B



CHELSEA



E27 LED

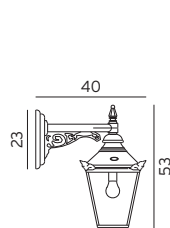

CHELSEA RANGE

IP44, class II

Fabricated from copper and supplied with clear polycarbonate lens.

Copper fittings are supplied in a raw finish to allow natural patina over time.

Brackets and posts manufactured in aluminium and powder coated in black.

Art. 960
E27, 70W Halo. max.
Copper, 960CO

Accessories
Art. 152
Corner bracket for Art. 960.

Black, 152B

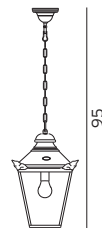

Art. 961
E27, 70W Halo. max.
Copper, 961CO

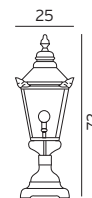

Art. 956
E27, 70W Halo. max.
Copper, 956CO

Accessories
Art. 307
Concreting anchor for Art. 956

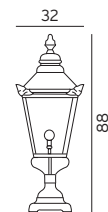

Art. 957
E27, 70W Halo. max.
Copper, 957CO

Accessories
Art. 307
Concreting anchor for Art. 957



Available with LED

CHELSEA

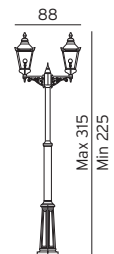
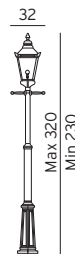
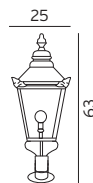

CHELSEA RANGE

IP44, class II

Fabricated from copper and supplied with clear polycarbonate lens.

Copper fittings are supplied in a raw finish to allow natural patina over time.

Brackets and posts manufactured in aluminium and powder coated in black.

Part of Chelsea range is available with LED

Contact your supplier for more information!

Art. 958

E27, 70W Halo. max.
Copper, 958CO

Art. 951

E27, 70W Halo. max.
Copper, 951CO

Art. 953

E27, 2x70W Halo. max.
Copper, 953CO

Accessories

Art. 305

Concreting anchor for Art. 951

Art. 306

Anchoring support for Art. 951

Hexagonal foot. 3 holes for anchoring. Distance between holes: 20,5 cm.

Accessories

Art. 305

Concreting anchor for Art. 953

Art. 306

Anchoring support for Art. 953

Hexagonal foot. 3 holes for anchoring. Distance between holes: 20,5 cm.

GENOVA MINI



GENOVA



VENEDIG

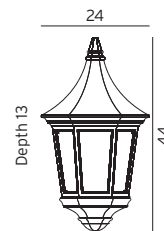
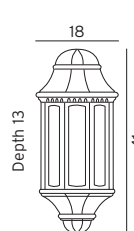
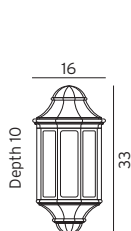

Available after request in color:
Black Copper.
Please specify lamp option (Art No) and finish at time of order.

**GENOVA MINI
Art. 175**
E27, 42W Halo. max.
IP 54, class II,
clear polycarbonate.

Black, 175B
Black green, 175BG
White, 175W

**GENOVA
Art. 170**
E27, 42W Halo. max.
IP54, class II,
clear polycarbonate.

Black, 170B
Black green, 170BG
White, 170W

**VENEDIG
Art. 261**
E27, 42W Halo. max.
IP54, class II,
clear polycarbonate.

Black, 261B
Black green, 261BG
White, 261W





GLASGOW



LATINA



ROMA

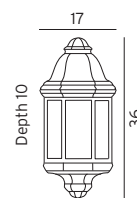
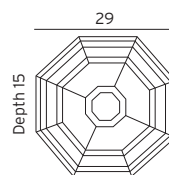
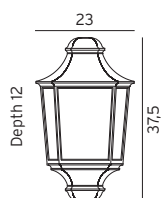

Available after request in color:
Black Copper.
Please specify lamp option (Art No) and finish at time of order.

**GLASGOW
Art. 730**
E27, 42W Halo. max.
IP54, class II,
clear polycarbonate.

Black, 730B
Black green, 730BG
White, 730W

**LATINA
Art. 105**
E27, 42W Halo. max.
IP44, class II,
frosted polycarbonate.

Black, 105B
Black green, 105BG
White, 105W

**ROMA
Art. 169**
E27, 42W Halo. max.
IP54, class II,
clear polycarbonate.

Black, 169B
Black green, 169BG
White, 169W



Concerns Rimini/ Milano range.
Glass: clear polycarbonate lens.
Class II, IP 54.

Rimini range contains of art. 259,
2591, 250, 402, 403 og 404.
Milano range contains of art. 401

Milano/ Rimini art. 401, 402 and 403
has hexagonal foot. Distance between
bolt holes is 17,5 cm (three bolts).
Art. 404 has a square feet. Distance
between the two bolt holes is 9 cm.

<p>Art. 259 E27, 42W Halo max. Black, 259B Black green, 259BG White, 259W</p>	<p>Art. 2591 E27, 42W Halo max. Black, 2591B Black green, 2591BG White, 2591W</p>	<p>Art. 250 E27, 42W Halo max. Black, 250B Black green, 250BG White, 250W</p>	<p>Art. 404 E27, 42W Halo max. Black, 404B Black green, 404BG White, 404W</p>	<p>Art. 401 E27, 70W Halo max. Black, 401B Black green, 401BG White, 401W</p>	<p>Art. 402 E27, 2x42W Halo max. Black, 402B Black green, 402BG White, 402W</p>	<p>Art. 403 E27, 3x42W Halo max. Black, 403B Black green, 403BG White, 403W</p>
<p>Accessories Art. 150 Corner bracket for Art. 259 and 2591</p> <p>Black, 150B Black green, 150BG White, 150W</p>	<p>Accessories Art. 150 Corner bracket for Art. 259 and 2591</p> <p>Black, 150B Black green, 150BG White, 150W</p>	<p>Accessories Art. 307 Concreting anchor for Art. 250 and 404.</p>	<p>Accessories Art. 307 Concreting anchor for Art. 250 and 404.</p>	<p>Accessories Art. 405 Concreting anchor for Art.401</p>	<p>Accessories Art. 405 Concreting anchor for Art.402</p>	<p>Accessories Art. 405 Concreting anchor for Art.403</p>
				<p>Art. 406 Anchoring support for Art. 401</p>	<p>Art. 406 Anchoring support for Art. 402</p>	<p>Art. 406 Anchoring support for Art. 403</p>

BOLOGNA



Bologna range.
Globe: Clear tinted polycarbonate or opal polycarbonate globe.
Class II, IP54.

Art. 362, 363, 364 och 365
Hexagonal foot. 3 holes for anchoring. Distance between holes: 20,5 cm. (three bolts).

Art. 312, 313, 314 och 315
has a square feet 16,5 cm. Distance between the two bolt holes is 9 cm.

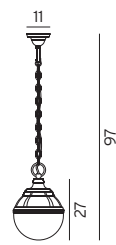
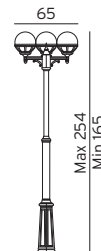
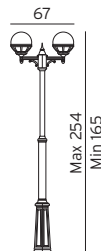
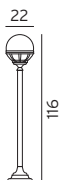
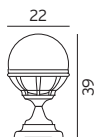
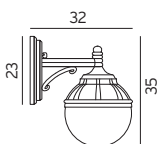
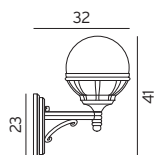

Art. 360
tinted globe.
E27, 42W Halo max.
Black, 360B
Black green, 360BG
White, 360W
Art. 361, *opal globe.*
Black, 361B
Black green, 361BG
White, 361W

Art. 310
tinted globe.
E27, 42W Halo max.
Black, 310B
Black green, 310BG
White, 310W
Art. 311, *opal globe.*
Black, 311B
Black green, 311BG
White, 311W

Art. 312
tinted globe.
E27, 42W Halo max.
Black, 312B
Black green, 312BG
White, 312W
Art. 313, *opal globe.*
Black, 313B
Black green, 313BG
White, 313W

Art. 314
tinted globe.
E27, 42W Halo max.
Black, 314B
Black green, 314BG
White, 314W
Art. 315, *opal globe.*
Black, 315B
Black green, 315BG
White, 315W

Art. 362,
tinted globe.
E27, 2x42W Halo.
Black, 362B
Black green, 362BG
White, 362W
Art. 363,
opal globe.
Black, 363B
Black green, 363BG
White, 363W

Art. 364
tinted globe.
E27, 3x42W Halo.
Black, 364B
Black green, 364BG
White, 364W
Art. 365
opal globe.
Black, 365B
Black green, 365BG
White, 365W

Art. 310A
tinted globe.
E27, 42W Halo.
Black, 310A/B
Black green, 310A/BG
White, 310A/W
Art. 311A, *opal globe.*
Black, 311A/B
Black green, 311A/BG
White, 311A/W

Accessories

Art. 152
Corner bracket for Art. 360, 361, 310 and 311
Black, 152B
Black green, 152BG
White, 152W

Accessories

Art. 307
Concreting anchor for Art. 312, 313, 314 and 315.

Accessories

Art. 305, Concreting anchor for Art. 362, 363, 364 and 365.
Art. 306, Anchoring support for Art. 362, 363, 364 and 365.



BOLOGNA



E27

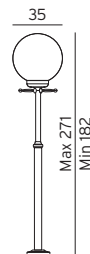
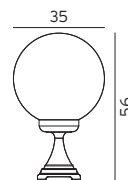
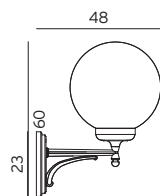

Bologna range.
Globe: Clear tinted polycarbonate or opal polycarbonate globe.
Class II, IP54.

Art. 331 and 341
Hexagonal foot. 3 holes for anchoring. Distance between holes: 20,5 cm. (three bolts).

Art. 333 and 343
has a square feet 16,5 cm. Distance between the two bolt holes is 9 cm.

Art. 330
E27, 70W Halo. *tinted globe*.
Black, 330B
Black green, 330BG
White, 330W
Art. 340
E27, 70W Halo. *opal globe*.
Black, 340B
Black green, 340BG
White, 340W
Accessories
Art. 152
Corner bracket
Black, 152B
Black green, 152BG
White, 152W

Art. 333
E27, 70W Halo. *tinted globe*.
Black, 333B
Black green, 333BG
White, 333W
Art. 343
E27, 70W Halo. *opal globe*.
Black, 343B
Black green, 343BG
White, 364W
Accessories
Art. 307
Concreting anchor
for Art. 333, 343.

Art. 331
E27, 70W Halo. *tinted globe*.
Black, 331B
Black green, 331BG
White, 331W
Art. 341
E27, 70W Halo. *opal globe*.
Black, 341B
Black green, 341BG
White, 341W
Accessories
Art. 405
Concreting anchor for Art. 331 and 341
Art. 406
Anchoring support for Art. 331 and 341



LONDON



All London range.
Clear polycarbonate lens.
IP54, class II.

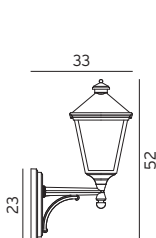

Art. 480
E27, 70W Halo. max.
Black, 480B
Black green, 480BG
White, 480W

Accessories
Art. 152
Corner bracket for
Art. 480.
Black, 152B
Black green, 152BG
White, 152W

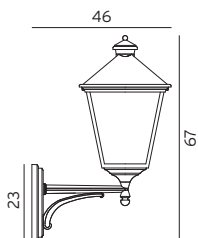

Art. 490
E27, 70W Halo. max.
Black, 490B
Black green, 490BG
White, 490W

Accessories
Art. 152
Corner bracket for
Art. 490.
Black, 152B
Black green, 152BG
White, 152W

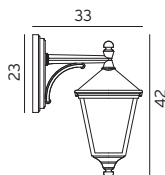

Art. 481
E27, 70W Halo. max.
Black, 481B
Black green, 481BG
White, 481W

Accessories
Art. 152
Corner bracket for
Art. 481.
Black, 152B
Black green, 152BG
White, 152W

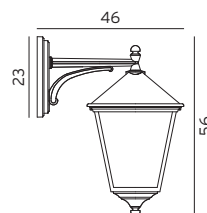

Art. 493
E27, 70W Halo. max.
Black, 493B
Black green, 493BG
White, 493W

Accessories
Art. 152
Corner bracket for
Art. 493.
Black, 152B
Black green, 152BG
White, 152W

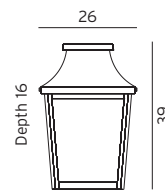

Art. 497
IP65
E27, 53W Halo. max.
Black, 497B
Black green, 497BG
White, 497W



ART. 490





LONDON



E27

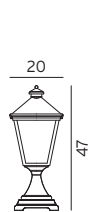

Art. 484
E27, 70W Halo. max.
Black, 484B
Black green, 484BG
White, 484W

Accessories

Art. 307
Concreting anchor
for Art. 484

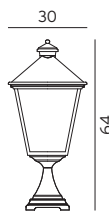

Art. 494
E27, 70W Halo. max.
Black, 494B
Black green, 494BG
White, 494W

Accessories

Art. 307
Concreting anchor
for Art. 494.

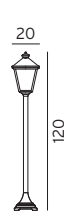

Art. 485
E27, 70W Halo. max.
Black, 485B
Black green, 485BG
White, 485W

Accessories

Art. 307
Concreting anchor
for Art. 485.



Art. 481A
E27, 70W Halo. max.
Black, 481A/B
Black green, 481A/BG
White, 481A/W

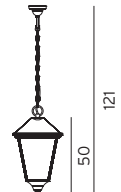

Art. 493A
E27, 70W Halo. max.
Black, 493A/B
Black green, 493A/BG
White, 493A/W

All London range.
IP54, class II.
Clear polycarbonate lens.

Art. 484 and 485
square base- 16,5 cm. Distance
between the two holes 9 cm.

Art. 494
square base- 20 cm. Distance
between the two holes 9 cm.

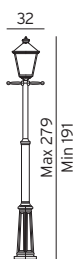

Art. 491
E27, 70W Halo. max.
Black, 491B
Black green, 491BG
White, 491W

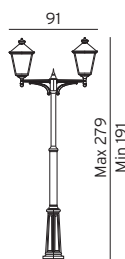

Art. 492
E27, 2x70W Halo. max.
Black, 492B
Black green, 492BG
White, 492W

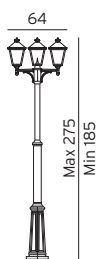

Art. 483
E27, 3x70W Halo. max.
Black, 483B
Black green, 483BG
White, 483W

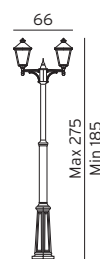

Art. 482
E27, 2x70W Halo. max.
Black, 482B
Black green, 482BG
White, 482W

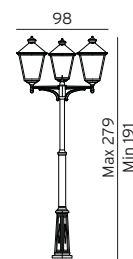

Art. 495
E27, 3x70W Halo. max.
Black, 495B
Black green, 45BG
White, 452W

All London range.
IP54, class II.
Clear polycarbonate lens.

Hexagonal foot. Distance between the three holes is 20,5 cm.

Accessories

Art. 305
Concreting anchor for London Range

Art. 306
Anchoring support for London Range







Available with LED

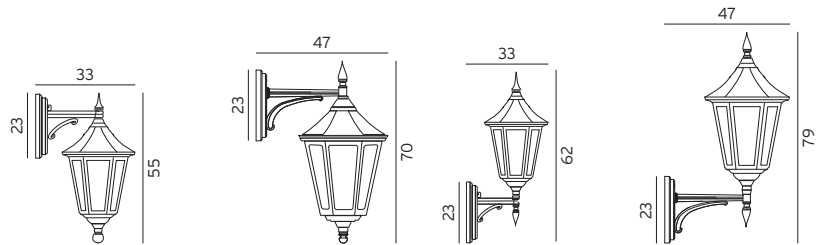

MODENA



All Modena range.
IP 54, class II.
Supplied with lightly tinted polycarbonate lens

Part of Modena range is available with LED 
IP 65

Contact your supplier for more information!

Art. 351
E27, 70W Halo. max.
Black, 351B
Black green, 351BG
White, 351W

Accessories
Art. 152
Corner bracket for Art. 351.
Black, 152B
Black green, 152BG
White, 152W

Art. 381
E27, 70W Halo. max.
Black, 381B
Black green, 381BG
White, 381W

Accessories
Art. 152
Corner bracket for Art. 381.
Black, 152B
Black green, 152BG
White, 152W

Art. 350
E27, 70W Halo. max.
Black, 350B
Black green, 350BG
White, 350W

Accessories
Art. 152
Corner bracket for Art. 350.
Black, 152B
Black green, 152BG
White, 152W

Art. 380
E27, 70W Halo. max.
Black, 380B
Black green, 380BG
White, 380W

Accessories
Art. 152
Corner bracket for Art. 380.
Black, 152B
Black green, 152BG
White, 152W







MODENA



E27 LED

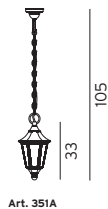

Art. 351A

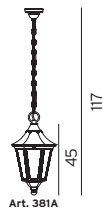

Art. 381A



Art. 300

E27, 70W Halo. max.
Black, 300B
Black green, 300BG
White, 300W

Accessories

Art. 307
Concreting anchor
for Art. 300

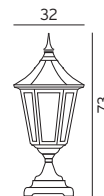

Art. 384

E27, 70W Halo. max.
Black, 384B
Black green, 384BG
White, 384W

Accessories

Art. 307
Concreting anchor
for Art. 384



Art. 304

E27, 70W Halo. max.
Black, 304B
Black green, 304BG
White, 304W

Accessories

Art. 307
Concreting anchor
for Art. 304

All Modena range.
IP 54, class II.
Supplied with lightly tinted
polycarbonate lens

Art. 300 and 304

Square base (16,5cm x
16,5 cm).

Distance between the two
holes 9 cm.

Art. 384

square base- 20 cm.

Distance between the two
holes 9 cm.

**Part of Modena range
is available with LED** 
IP 65

Contact your supplier for
more information!

Art. 351A (chain)

E27, 70W Halo. max.
Black, 351A/B
Black green, 351A/BG
White, 351A/W

Art. 381A BIG (chain)

E27, 70W Halo. max.
Black, 381A/B
Black green, 381A/BG
White, 381A/W

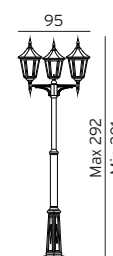
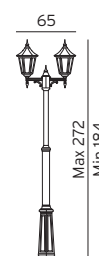
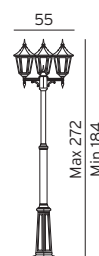
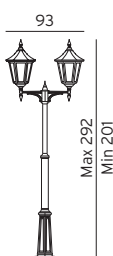
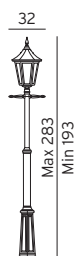

All Modena range.
IP 54, class II.
Supplied with lightly tinted polycarbonate lens

Hexagonal foot. Distance between the three holes is 20,5 cm.

Part of Modena range is available with LED 

Contact your supplier for more information!

Art. 301
E27, 70W
Halo. max.
Black, 301B
Black green, 301BG
White, 301W

Accessories
Art. 305 Concreting anchor for Art. 301
Art. 306 Anchoring support for Art. 301

Art. 382
E27, 2x70W
Halo. max.
Black, 382B
Black green, 382BG
White, 382W

Accessories
Art. 305 Concreting anchor for Art. 382
Art. 306 Anchoring support for Art. 382

Art. 303
E27, 3x70W
Halo. max.
Black, 303B
Black green, 303BG
White, 303W

Accessories
Art. 305 Concreting anchor for Art. 303
Art. 306 Anchoring support for Art. 303

Art. 302
E27, 2x70W
Halo. max.
Black, 302B
Black green, 302BG
White, 302W

Accessories
Art. 305 Concreting anchor for Art. 302
Art. 306 Anchoring support for Art. 302

Art. 397
E27, 3x70W
Halo. max.
Black, 397B
Black green, 397BG
White, 397W

Accessories
Art. 305 Concreting anchor for Art. 397
Art. 306 Anchoring support for Art. 397



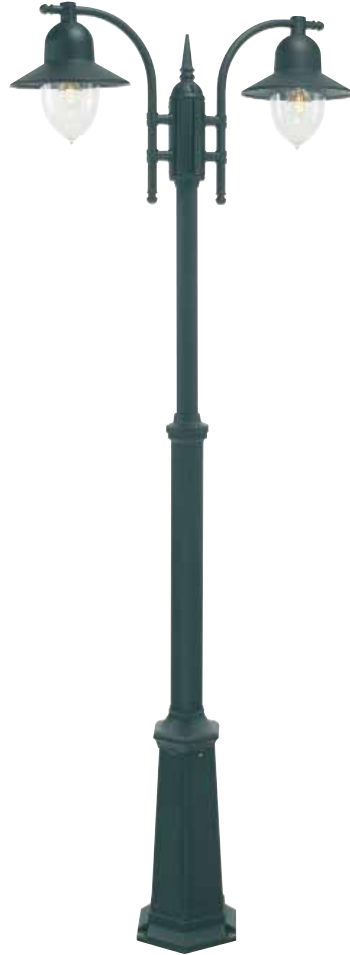

COMO



E27

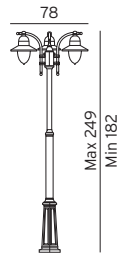
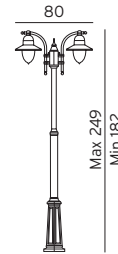
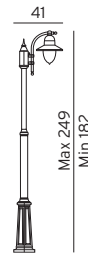
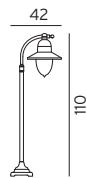
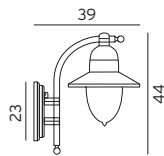

All Como range.
IP54, class II.
Lightly tinted polycarbonate.
Opal polycarbonate on request.

371, 372 og 373

Hexagonal foot. Distance between the three holes is 20,5 cm.

375

Square base- 16,5 cm.
Distance between the two holes 9 cm.

Art. 370
E27, 53W Halo. max.
Black, 370B
Black green, 370BG
White, 370W

Accessories

Art. 152
Corner bracket for Art. 370.
Black, 152B
Black green, 152BG
White, 152W

Art. 375
E27, 53W Halo. max.
Black, 375B
Black green, 375BG
White, 375W

Accessories

Art. 307
Concreting anchor for Art. 375

Art. 371
E27, 53W Halo. max.
Black, 371B
Black green, 371BG
White, 371W

Accessories

Art. 305
Concreting anchor for Art. 371
Art. 306
Anchoring support for Art. 371

Art. 372
E27, 2x53W Halo. max.
Black, 372B
Black green, 372BG
White, 372W

Accessories

Art. 305
Concreting anchor for Art. 372
Art. 306
Anchoring support for Art. 372

Art. 373
E27, 3x53W Halo. max.
Black, 373B
Black green, 373BG
White, 373W

Accessories

Art. 305
Concreting anchor for Art. 373
Art. 306
Anchoring support for Art. 373



FIRENZE



All Firenze range.
IP54, class II.
Lightly tinted polycarbonate.
Opal polycarbonate on request.

Art. 800A
E27, 53W
Halo. max.
Black, 800A/B
Black green, 800A/BG
White, 800A/W

Art. 800
E27, 53W
Halo. max.
Black, 800B
Black green, 800BG
White, 800W

Art. 805
E27, 53W
Halo. max.
Black, 805B
Black green, 805BG
White, 805W

Art. 810
E27, 53W
Halo. max.
Black, 810B
Black green, 810BG
White, 810W

Art. 820
E27, 2x53W
Halo. max.
Black, 820B
Black green, 820BG
White, 820W

Art. 830
E27, 3x53W
Halo. max.
Black, 830B
Black green, 830BG
White, 830W

Art. 810, 811, 820
Hexagonal foot.
Distance between the three holes is 20,5 cm.

Art. 805
Square base- 16,5 cm.
Distance between the two holes 9 cm.

Accessories
Art. 152
Corner bracket for Art. 800
Black, 152B
Black green, 152BG
White, 152W

Accessories
Art. 307
Concreting anchor for Art. 805

Accessories
Art. 305
Concreting anchor for Art. 810, 820 and 830
Art. 306
Anchoring support for Art. 810, 820 and 830

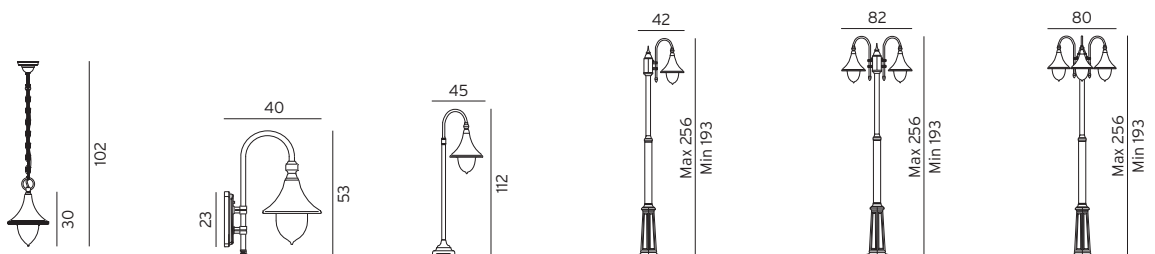

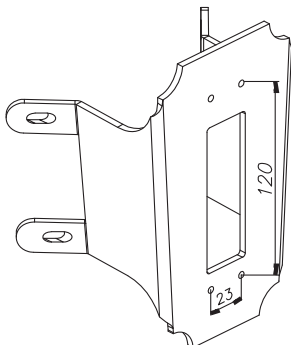

Art. 150
Corner bracket
Rimini

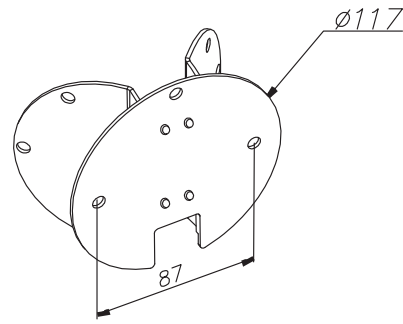

Art. 153
Corner bracket
Stockholm
Oslo
Lund
Bergen
Karlstad

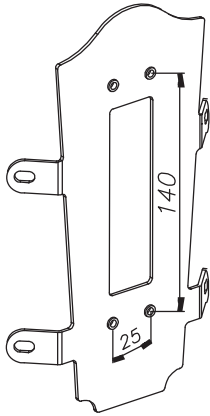

Art. 152
Corner bracket
Chelsea
Bologna
London
Modena
Como
Firenze

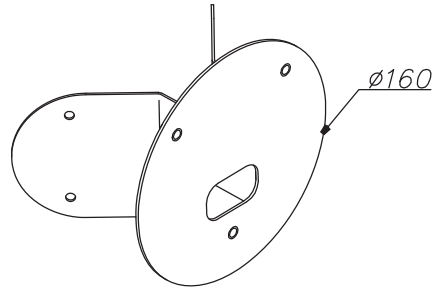



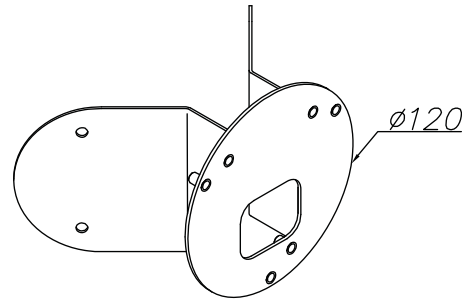





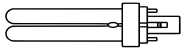



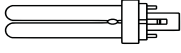

Art. 156
Corner bracket
Helsinki
(Only 880,
882, 883)

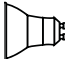

Art. 158
Corner bracket
Helsinki
Koster

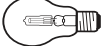
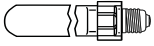
ACCESSORIES FOR NORLYS LAMPS

Lamps	Socket
TC-D 	G24d-1 -2 -3   
TC-DEL 	G24q-1 -2 -3   
HALOGEN LED 	GU10 
HIT 	G12 
HALOGEN A 50 A 55 	Standard socket E27
HSE  HSE 	Standard socket E27

Notes :

As GLS lamps are being phased out over the next few years the table below shows the alternative halogen lamps that can be used. Eg. If 60W is the recommended GLS Wattage then please use max. 42W halogen lamp.

HALOGEN	GLS
28W	40W
42W	60W
53W	75W
70W	100W

Look for LED products: See the green house



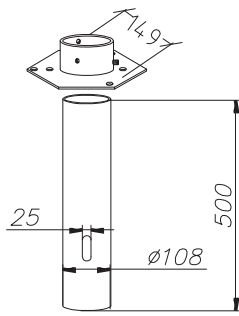

Art. 110
Anchoring support
Narvik

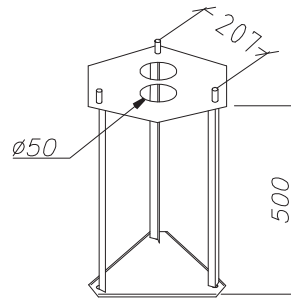

Art. 306
Anchoring support
Chelsea
Bologna
London
Modena
Como
Firenze

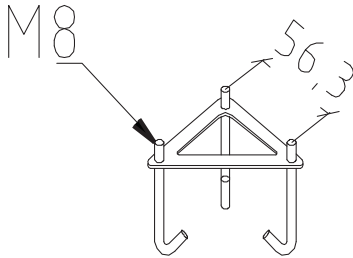

Art. 205
Concreting anchor
Halmstad bollard
Stockholm bollard
Alta Bollard
Scandinavian wood
Arendal bollard

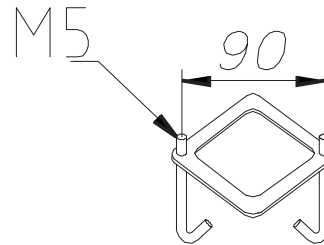

Art.307
Concreting anchor
Chelsea
Bologna
London
Modena
Como
Firenze

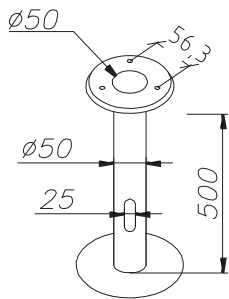

Art. 206
Anchoring support
Halmstad bollard
Stockholm bollard
Alta Bollard
Scandinavian wood
Arendal bollard

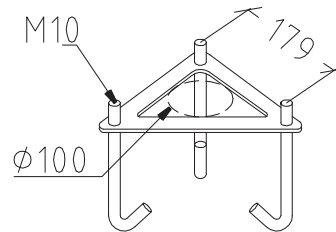

Art. 405
Concreting anchor
Stockholm
Oslo
Lund
Rimini/Milano

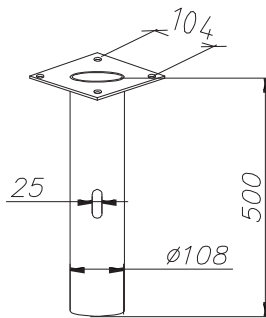

Art. 207
Anchoring support
Arvika

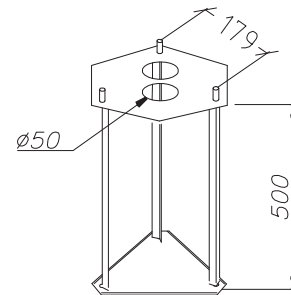

Art. 406
Anchoring support
Stockholm
Oslo
Lund
Rimini/Milano

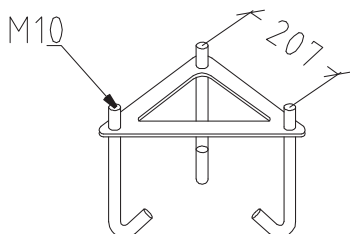

Art. 305
Concreting anchor
Chelsea
Bologna
London
Modena
Como
Firenze

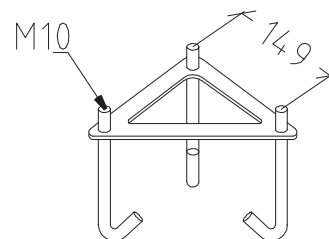

Art. 505
Concreting anchor
Narvik

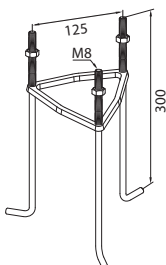

Art. 1230
Concreting anchor
Stavanger

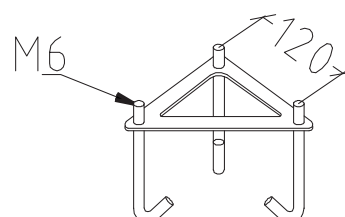

Art. 1128
Concreting anchor
Oslo 245
Arvika 890-897
Stockholm 285, 287



Foto: p. 79: Côté Ouest/ Jean-Marc Patisse
Foto: Studio Fugleseth

Norlys AS
P.B 1014 Hoff, 0218 Oslo
Hovfaret 4, 0275 Oslo
Tel. +47 24 12 40 10
fax. +47 24 12 40 11
www.norlys.com
E-mail: firmapost@norlys.no